



INSTALLATION INSTRUCTIONS FOR PART 95-3106

APPLICATIONS

SATURN

2003-05 Ion / 2000-05 LS
2000-02 SL / 2002-05 Vue

95-3106



KIT FEATURES

- Double DIN Head Unit Provision
- Stacked ISO DIN Head Unit Provision

KIT COMPONENTS

- A) DDIN Brackets
- B) DDIN Trim Plate

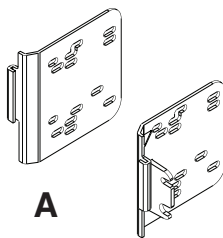

A

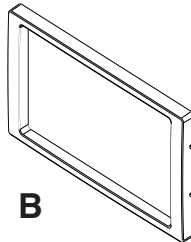

B

WIRING CONNECTIONS (Sold Separately)

HARNESS:

- 70-2102 - GM 2004-05 HARNESS
- 70-2002 - SATURN 2000-05 HARNESS

TOOLS REQUIRED:

- Phillips Screwdriver
- Panel Removal Tool
- Socket Set

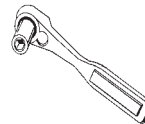
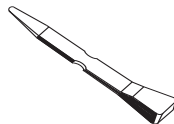
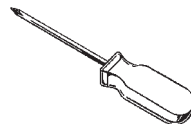

METRA. THE WORLD'S BEST KITS.™



1-800-221-0932



www.metraonline.com



95-3106

TABLE OF CONTENTS

Dash Disassembly

2003-2005 Saturn Ion	1
2000-2005 Saturn LS	1
2000-2002 Saturn SL	2
2002-2005 Saturn Vue	3

Kit Assembly

DDIN / Stacked ISO DIN Head Unit Provisions	4
--	----------



KNOWLEDGE IS POWER

Enhance your installation and fabrication skills by enrolling in the most recognized and respected mobile electronics school in our industry. Log onto www.installerinstitute.com or call 800-354-6782 for more information and take steps toward a better tomorrow.



Metra recommends using MECP certified technicians.

2003-2005 SATURN ION

- 1 Disconnect the negative battery terminal to prevent an accidental short circuit.
- 2 Unclip and remove the trim panel surrounding the radio. (Figure A)
- 3 Remove (2) 9/32" screws from radio to remove. (Figure A)

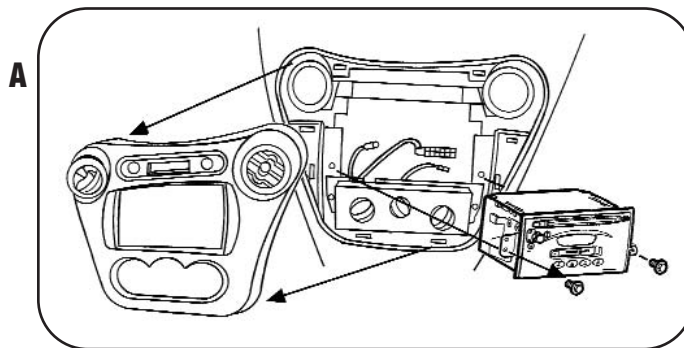

2000-2005 SATURN LS

- 1 Disconnect the negative battery terminal to prevent an accidental short circuit.
- 2 Unclip and remove the trim panel surrounding the radio. (Figure B)
- 3 Remove (2) 9/32" screws from radio to remove. (Figure B)

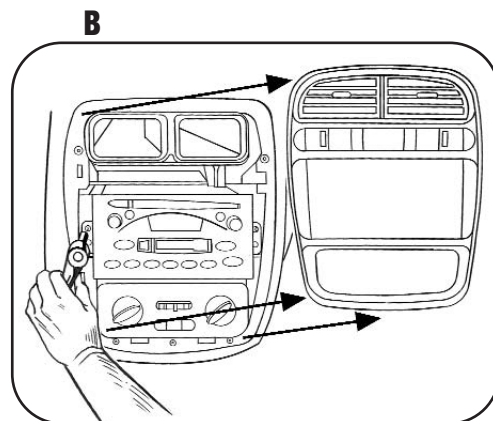

DASH DISASSEMBLY

2000-2002 SATURN SL

- 1 Disconnect the negative battery terminal to prevent an accidental short circuit.
- 2 Remove (4) Phillips from panel below steering column and unclip and remove. (Figure A)
- 3 Remove (4) Phillips screws from the steering column trim panel and remove. (Figure B)
- 4 Remove (2) screws from the end cap/vent on the left side of the steering column then unclip and remove. (Figure C)
- 5 Unclip and remove the entire dash panel surrounding the radio, instrument cluster and a/c controls. (Figure D)
- 6 Remove (2) 9/32" screws securing the head unit to remove. (Figure D)

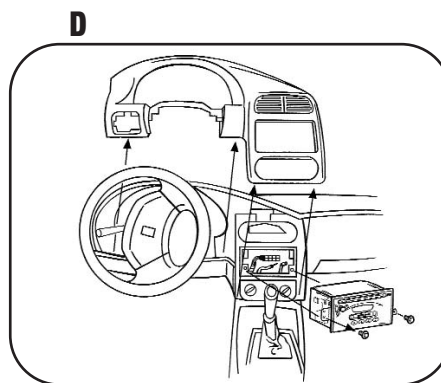
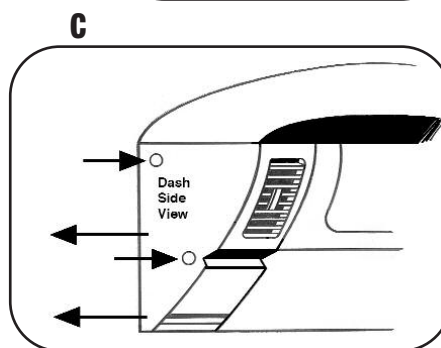
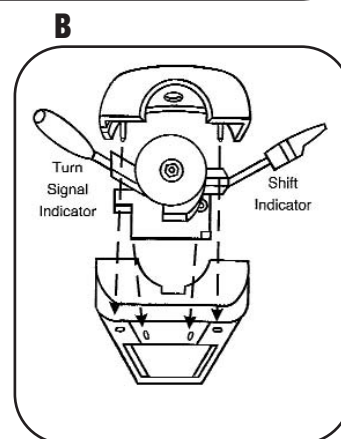
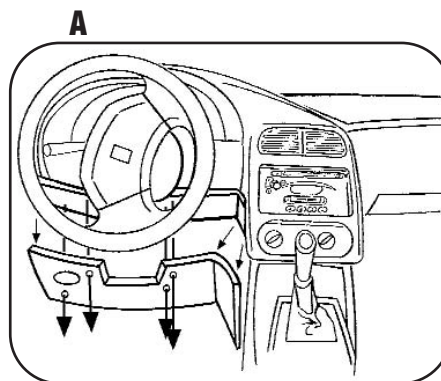

2002-2005 SATURN VUE

- 1** Disconnect the negative battery terminal to prevent an accidental short circuit.
- 2** Unsnap and remove shifter trim panel. (Figure A)
- 3** Remove (4) 9/32" screws from the dash pocket and remove. (Figure A)
- 4** Unsnap and remove panel surrounding radio and a/c controls.(Figure A)
- 5** Remove (2) 9/32" screws from radio to remove. (Figure A)

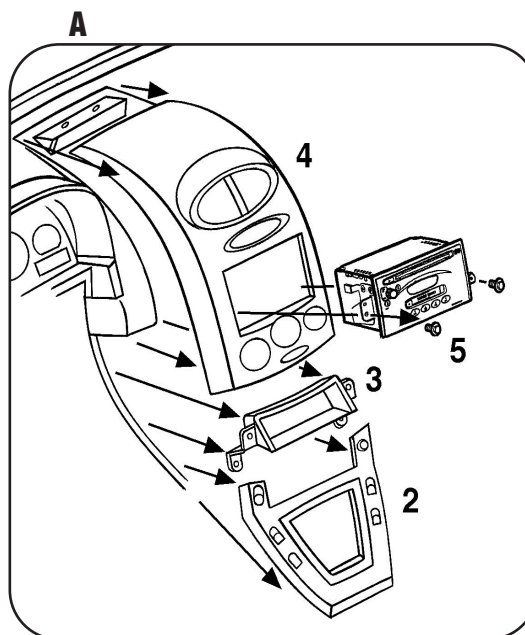

DASH DISASSEMBLY

**DOUBLE DIN / STACKED ISO DIN
HEAD UNIT PROVISIONS**

- 1** Locate the factory wiring harness in the dash. Metra recommends using the proper mating adapter from Metra or AXCESS. Re-connect the negative battery terminal and test the unit for proper operation.
- 2** Attach the Double DIN brackets to the Double DIN trim plate. (Figure A)
- 3** Slide the bracket/radio housing assembly over the Double DIN head unit and secure using the screws supplied with the radio. (Figure B)
- 4** Reassemble dash in reverse order of disassembly.

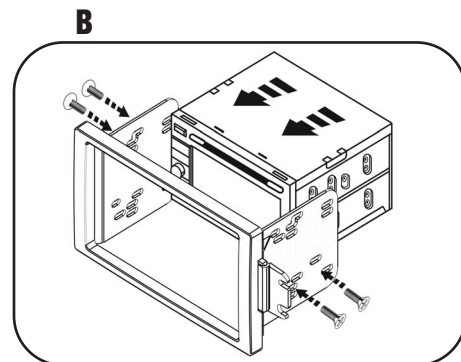
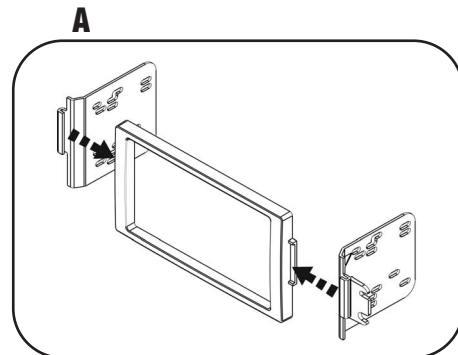



95-3106

NOTES

A large rectangular area on the page is defined by a thin black border. This area contains 25 horizontal lines, providing a space for handwritten notes. The lines are evenly spaced and extend across most of the width of the page.

INST95-3106

METRA. THE WORLD'S BEST KITS.™



1-800-221-0932



www.metraonline.com

© COPYRIGHT 2004 METRA ELECTRONICS CORPORATION

INST95-3106