



## Honda Accord 2013-2017

Visit [MetraOnline.com](http://MetraOnline.com) for more detailed information about the product and up-to-date vehicle specific applications

### KIT FEATURES

- ISO DDIN radio provision
  - ISO DIN radio provision with pocket sold separately
  - Painted two-tone to match the factory dash
- 95-7804B - Black with Silver accent
  - 95-7804HG - Black with High Gloss accent
  - Factory screen is no longer operational.

### KIT COMPONENTS

- A) Radio housing trim panel • B) Radio brackets • C) Top bracket • D) (6) White panel clips • E) (8) #6 x 3/8" Phillips screws
- F) (4) #8 x 3/8" Phillips screws

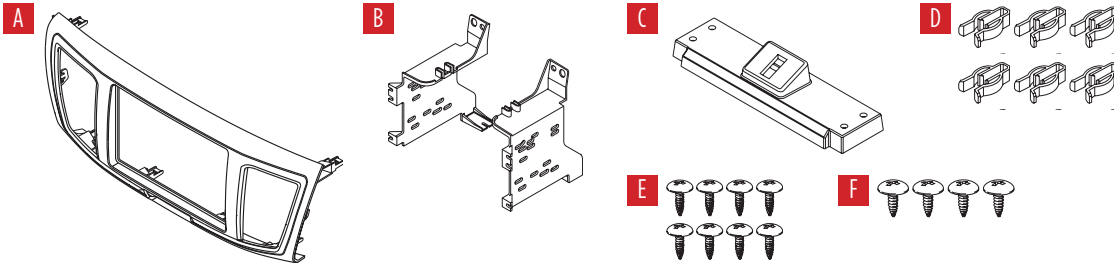

### TABLE OF CONTENTS

Dash Disassembly .....	2-3
Kit Preparation.....	4
Kit Assembly .....	5

### WIRING & ANTENNA CONNECTIONS

Suggested AXCESS interface AXHN-3.

Visit [axcessinterfaces.com](http://axcessinterfaces.com) or [metraonline.com](http://metraonline.com) for additional A/V and steering wheel control interface options.

Antenna Adapter: 40-HD11

For models EX and up use 40-HD12 plus 44-EC204 (at tuner brain in rear of car)

### TOOLS REQUIRED

- Panel removal tool • Phillips screwdriver

**Attention!** With the key out of the ignition, disconnect the negative battery terminal before installing this product. Ensure that all installation connections are secure before cycling the ignition to test this product.

## DASH DISASSEMBLY

1. Unclip and remove the side trim panels from each side of the console. (Figure A)
2. Remove (2) Phillips screws exposed on pocket then remove the pocket. (Figure B)
3. Remove (2) 8mm screws facing up on bottom of radio chassis inside pocket cavity. (Figure C)

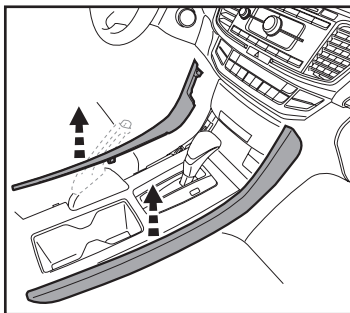

(Figure A)

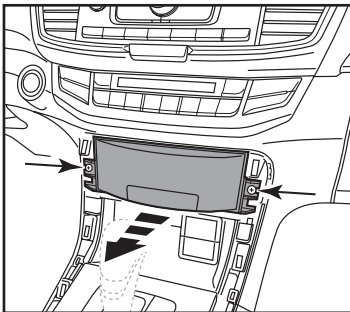

(Figure B)

4. Unclip and remove the small trim panel between the radio and steering column.

**Note:** Models with auto climate will have a thermistor hose attached to this panel. Disconnect the hose under the dash above the gas pedal to give it enough slack before re-installing the panel.

5. Unclip the tray above the radio by prying up on the outside corners. Remove tray. (Figure D)

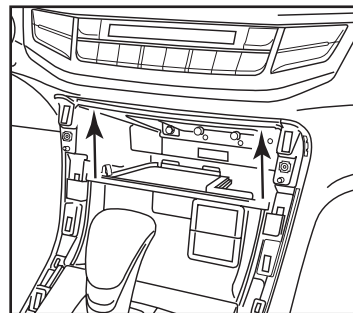

(Figure C)

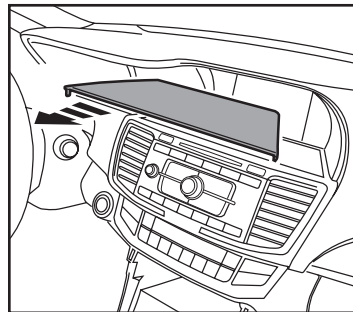

(Figure D)

*Continue on the next page*

## DASH DISASSEMBLY (CONT)

6. Remove (2) Phillips screws on top of radio. (Figure E)
7. Unclip and remove the radio assembly. (Figure F)

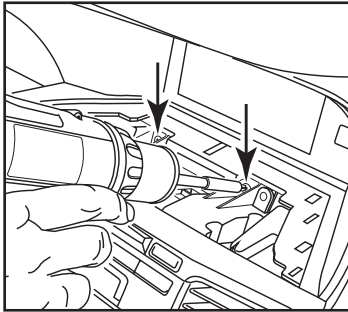

(Figure E)

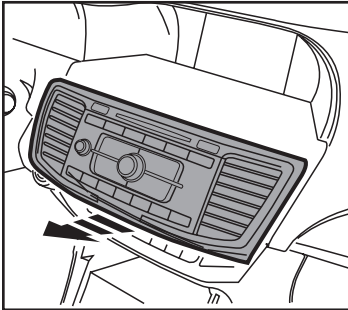

(Figure F)

8. Remove (1) Phillips screw from each A/C vent then unclip and remove the vents. (Figure G)
9. Remove (2) Phillips screws securing the hazard light switch and retain for kit assembly.

*Continue to Kit Preparation*

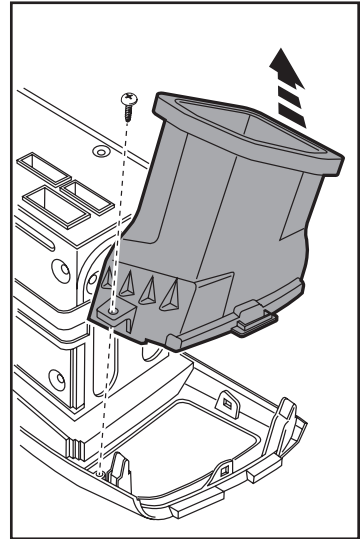

(Figure G)

## KIT PREPARATION

1. Attach the hazard light switch to the **radio trim panel** using (2) of the supplied #8 x 3/8" Phillips screws. (Figure A)
2. Attach the (6) **white panel clips** to the **radio housing trim panel**. (Figure A)

*Continue to Kit Assembly*

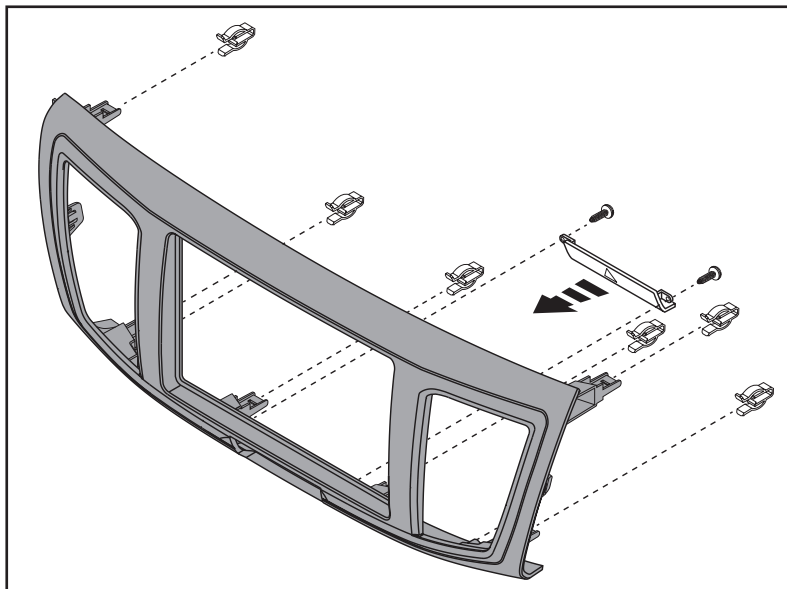

(Figure A)

## KIT ASSEMBLY

1. Attach the **radio brackets** to the **radio housing trim panel** using (4) of the #6 x 3/8" Phillips screws. (Figure A)
2. Attach the **top bracket** to the top of the **radio brackets** using (4) of the #6 x 3/8" Phillips screws supplied. (Figure B)
3. Slide the radio into the bracket/trim panel assembly and secure to the assembly using the screws supplied with the radio. (Figure C)
4. Attach the A/C vents to the **radio trim panel** and secure using (2) of the supplied #8 x 3/8" Phillips screws. (Figure D)

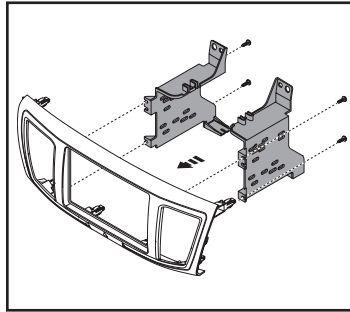

(Figure A)

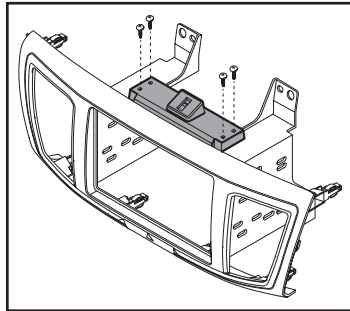

(Figure B)

5. Locate the factory wiring harness and antenna connector in the dash, and complete all necessary connections to the radio. Metra recommends using the proper mating adapter from Metra and/or AXCESS. Re-connect the negative battery terminal and test the radio for proper operation.
6. Reassemble the dash in reverse order of disassembly.

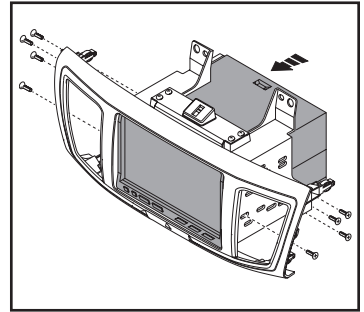

(Figure C)

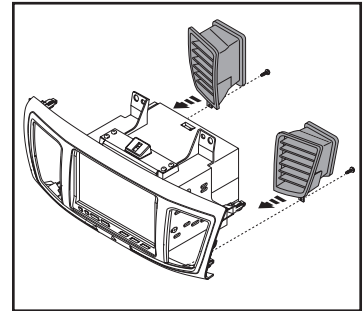

(Figure D)







**95-7804**  
INSTALLATION INSTRUCTIONS



Having difficulties? We're here to help.



Contact our Tech Support line at:

**386-257-1187**



Or via email at:

[techsupport@metra-autosound.com](mailto:techsupport@metra-autosound.com)

**Tech Support Hours (Eastern Standard Time)**

Monday - Friday: 9:00 AM - 7:00 PM

Saturday: 10:00 AM - 5:00 PM

Sunday: 10:00 AM - 4:00 PM



**Metra recommends MECP  
certified technicians**





## Honda Accord 2013-2017

Visite [MetraOnline.com](http://MetraOnline.com) para obtener información más detallada sobre el producto y aplicaciones específicas para vehículos actualizadas.

### CARACTERÍSTICAS DEL KIT

- Provisión de radio ISO DDIN 95-7804B - Negro con acento de plata
- Provisión de radio ISO DIN con bolsillo que se vende por separado 95-7804HG - Negro con acento de alto brillo
- Pintura en dos tonos para igualar el acabado de fábrica • La pantalla de fábrica ya no está operativa.

### COMPONENTES DEL KIT

- A) Panel de moldura de la carcasa del radio • B) Soportes • C) Soporte superior • D) (6) Ganchos blancos para panel
- E) (8) Tornillos Phillips #6 de 3/8" • F) (4) tornillos Phillips #8 de 3/8"

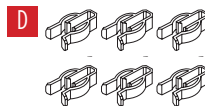
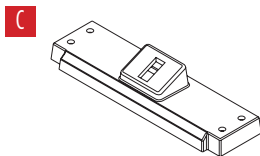
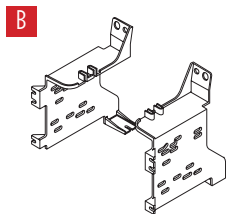
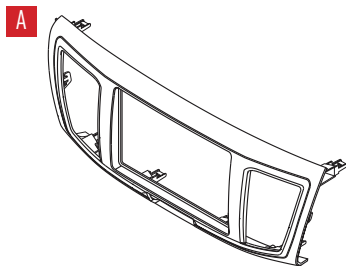

### INDICE

Desmontaje del tablero .....	2-3
Preparación de kit .....	4
Ensamble del kit .....	5

### CABLEADO Y CONEXIONES DE ANTENA

Interfaz AXCESS sugerida AXHN-3.  
 Visite [axcessinterfaces.com](http://axcessinterfaces.com) o [metraonline.com](http://metraonline.com) para obtener opciones adicionales de interfaz de control de volante y A/V.  
 Adaptador de antena: 40HD-11  
 Para los modelos EX y superiores, use 40-HD12 más 44-EC204 (en el cerebro del sintonizador en la parte trasera del automóvil)

### HERRAMIENTAS REQUERIDAS

- Herramienta para quitar paneles
- Destornillador Phillips

**¡Atención!** Deje que el vehículo se asiente con la llave fuera del encendido durante unos minutos antes de quitar la radio de fábrica. Al probar el equipo del mercado de accesorios, asegúrese de que todo el equipo de fábrica esté conectado antes de encender el llave de encendido.

## DESMONTAJE DEL TABLERO

1. Desenganche y quite los paneles de moldura laterales a cada lado de la consola. (Figura A)
2. Quite los (2) tornillos Phillips expuestos en la cavidad, luego quite la cavidad. (Figura B)
3. Quite los (2) tornillos de 8 mm orientados boca arriba de la parte inferior del chasis del radio en el interior de la cavidad. (Figura C)

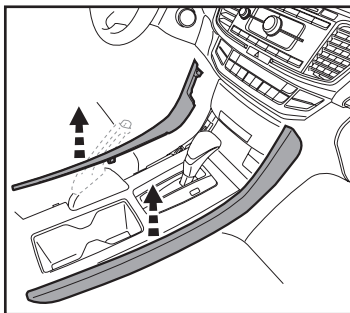

(Figura A)

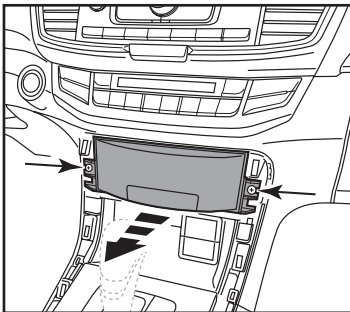

(Figura B)

4. Desenganche y quite el panel de la moldura pequeña entre el radio y la columna de dirección.

**Nota:** Los modelos con control automático de clima tendrán una manguera de termistor sujeta a este panel. Desconecte la manguera debajo del tablero y encima del pedal del acelerador para proporcionar suficiente holgura antes de volver a instalar el panel.

5. Suelte la bandeja que está sobre la radio haciendo palanca en las esquinas exteriores. Retire la bandeja. (Figura D)

*Continúa en la página siguiente*

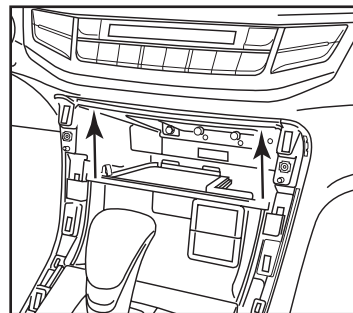

(Figura C)

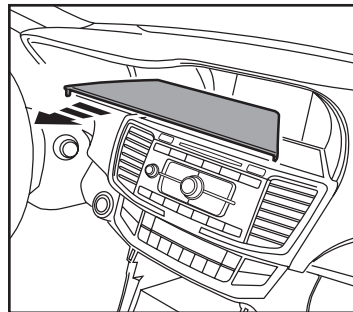

(Figura D)

## DESMONTAJE DEL TABLERO (CONT)

6. Quite los (2) tornillos Phillips que están arriba del radio. (Figura E)
7. Desenganche y quite el ensamble del radio. (Figura F)

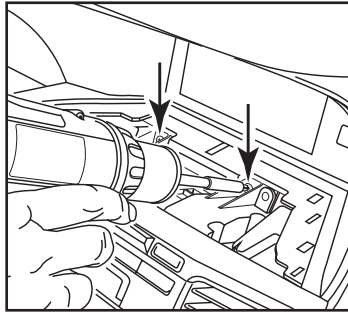

(Figura E)

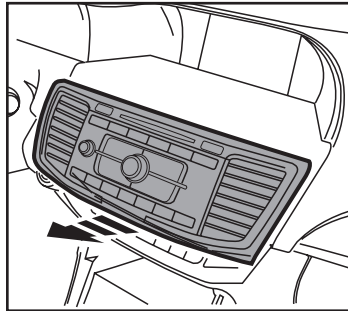

(Figura F)

8. Quite el (1) tornillo Phillips de cada rejilla de aire acondicionado y luego desenganche y quite las rejillas. (Figura G)
9. Quite los (2) tornillos Phillips que sujetan el interruptor de las luces intermitentes y guárdelos para el ensamble del kit.

*Continúe con la Preparación de Kit*

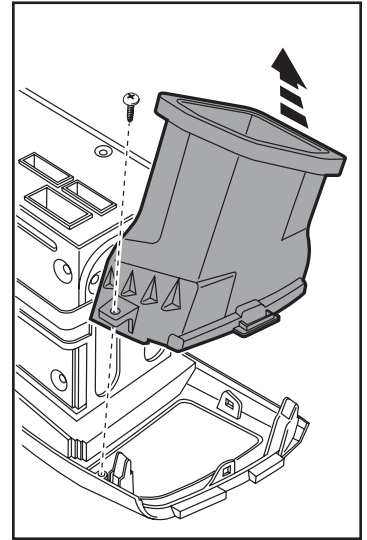

(Figura G)

## PREPARACIÓN DE KIT

1. Una el interruptor de las luces intermitentes al **panel de la moldura del radio** usando (2) de los tornillos Phillips suministrados #8 x 3/8". (Figura A)
2. Coloque los (6) **ganchos blancos del panel** en el **panel de la moldura de la carcasa del radio**. (Figura A)

*Continúe con el Ensamble del Kit*

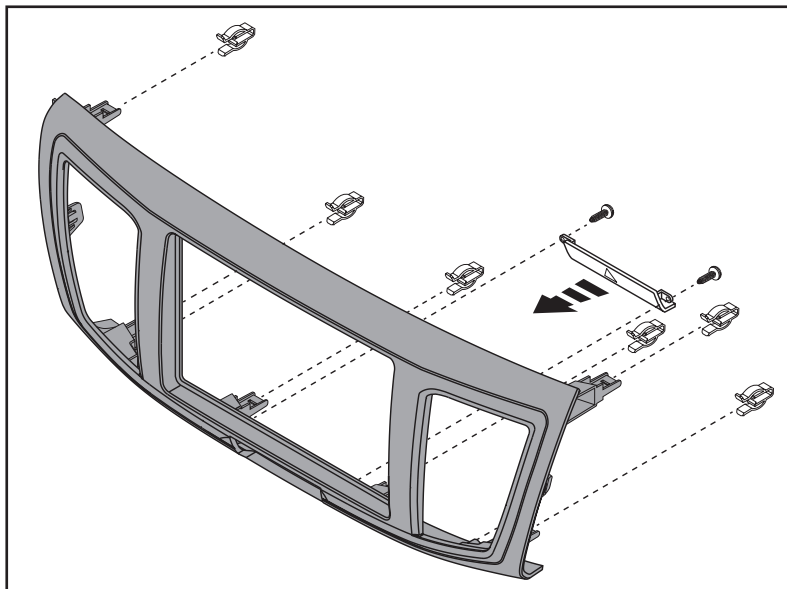

(Figura A)

## ENSAMBLE DEL KIT

1. Coloque los **soportes del radio** en el **panel de la moldura de la carcasa del radio** usando (4) de los tornillos Phillips suministrados #6 x 3/8". (Figura A)
2. Coloque el **soporte superior** arriba de los **soportes del radio** usando (4) de los tornillos Phillips suministrados #6 x 3/8". (Figura B)
3. Deslice el radio dentro del ensamble del soporte/panel de la moldura y sujételo al ensamble con los tornillos que vienen con el radio. (Figura C)
4. Una las rejillas de aire acondicionado al **panel de la moldura del radio** y sujételas usando (2) de los tornillos Phillips suministrados #8 x 3/8". (Figura D)

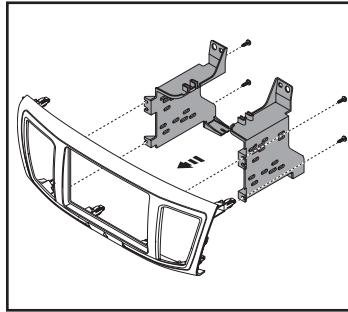

(Figura A)

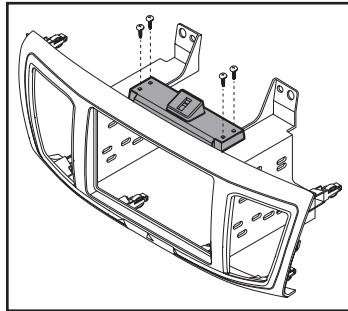

(Figura B)

5. Ubique el arnés del cableado de fábrica en el tablero. Metra recomienda usar el adaptador de acoplamiento adecuado de Metra o AXCESS. Vuelva a conectar el terminal negativo de la batería y pruebe la unidad para verificar que funcione correctamente.
6. Vuelva a armar el tablero al revés de como lo desarmó.

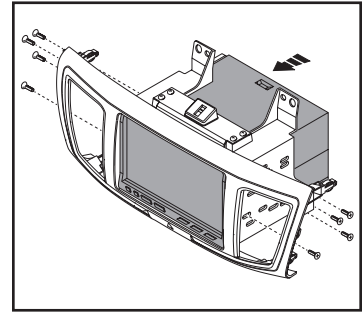

(Figura C)

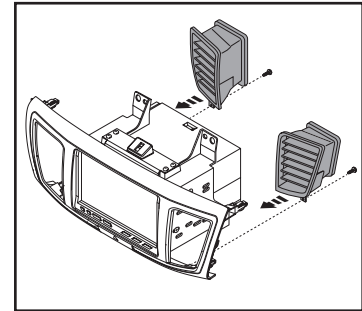

(Figura D)



---

---

---

---

---

---

---

---

---

---

---

---

---

---

---

---

---

---

---

---

---

---

---

---

---

---

---

---

---

---

---

---

---

---

---

---

---

---

---

---

---

---

---

---

---

---

---

---

---

---

---

---

---

---

---

---

---

---

---

---



---

---

---

---

---

---

---

---

---

---

---

---

---

---

---

---

---

---

---

---

---

---

---

---

---

---

---

---

---

---

---

---

---

---

---

---

---

---

---

---

---

---

---

---

---

---

---

---

---

---

---

---

---

---

---

---

---

---

---

---



**95-7804**  
INSTRUCCIONES DE INSTALACIÓN



¿Tienes dificultades? Estamos aquí para ayudar.



Póngase en contacto con nuestra  
línea de soporte técnico en:  
**386-257-1187**



O por correo electrónico a:  
[techsupport@metra-autosound.com](mailto:techsupport@metra-autosound.com)

**Horas de soporte técnico (hora estándar del este)**

Monday - Friday: 9:00 AM - 7:00 PM

Saturday: 10:00 AM - 5:00 PM

Sunday: 10:00 AM - 4:00 PM



**Metra recomienda MECP  
técnicos certificados**