



INSTALLATION INSTRUCTIONS FOR PART 99-1004

APPLICATIONS

HONDA

PASSPORT 1998-2002

ISUZU

Amigo 1998-2000

Rodeo 1998-2004

Rodeo Sport 2001-2003

99-1004

KIT FEATURES

- ISO and DIN Head Unit Provisions

KIT COMPONENTS

- A) Radio Housing • B) ISO Brackets • C) Trimplate

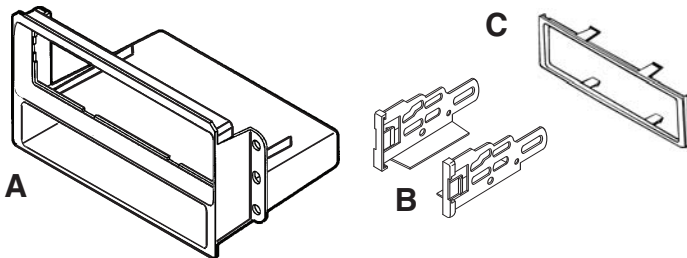

TOOLS REQUIRED:

- Phillips Screwdriver • Panel Removal Tool

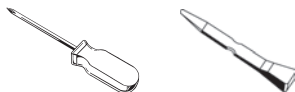

1-800-221-0932



www.metraonline.com

© COPYRIGHT 2001-2008 METRA ELECTRONICS CORPORATION



TABLE OF CONTENTS

***Dash Disassembly - All Vehicles* 1**

Kit and Final Assembly - All Vehicles

***DIN Head Unit Mount Radio Provision* 2,3,4,5**

ISO Head Unit Mount Radio Provision



KNOWLEDGE IS POWER

Enhance your installation and fabrication skills by enrolling in the most recognized and respected mobile electronics school in our industry.

Log onto www.installerinstitute.com or call 800-354-6782 for more information and take steps toward a better tomorrow.

ALL VEHICLES

Disconnect the negative battery terminal to prevent an accidental short circuit. Remove the ashtray and (1) Phillips screw exposed in the ashtray cavity. Remove (4) Phillips screws securing the factory head unit and disconnect the wiring.

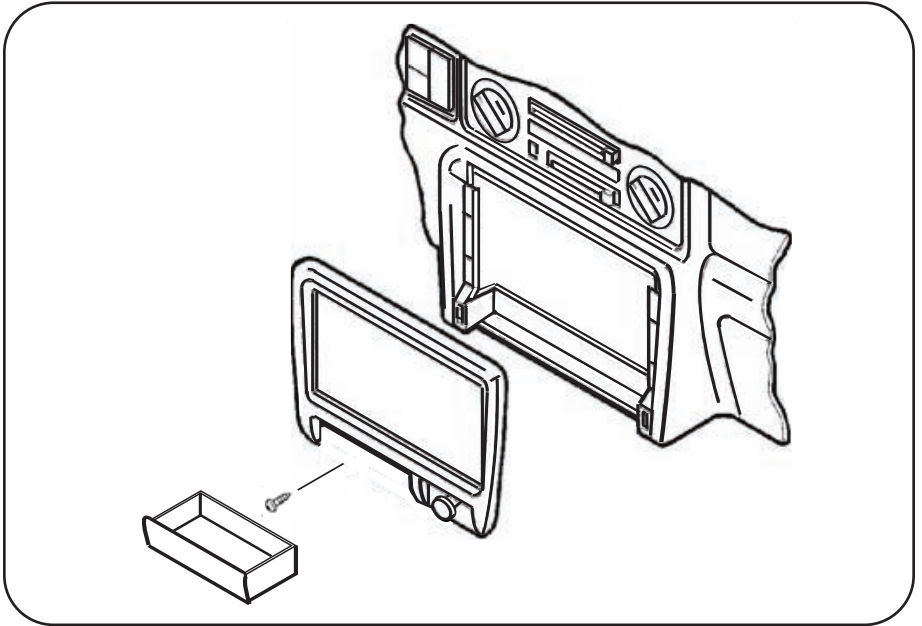

ALL VEHICLES

ISO HEAD UNITS: Snap the Trimplate into the Radio Housing. Attach the ISO Brackets to the inner lip of the Housing. Slide the head unit into the radio opening, align the holes in the head unit with the holes in the ISO Brackets and mount the unit to the brackets with the screws supplied with the unit. (See Fig. A).

DIN HEAD UNITS: Slide the DIN cage into the Housing and secure by bending the metal locking tabs down. Slide the aftermarket head unit into the cage and secure. Snap the *Trimplate into the Radio Housing. (See Fig. B)

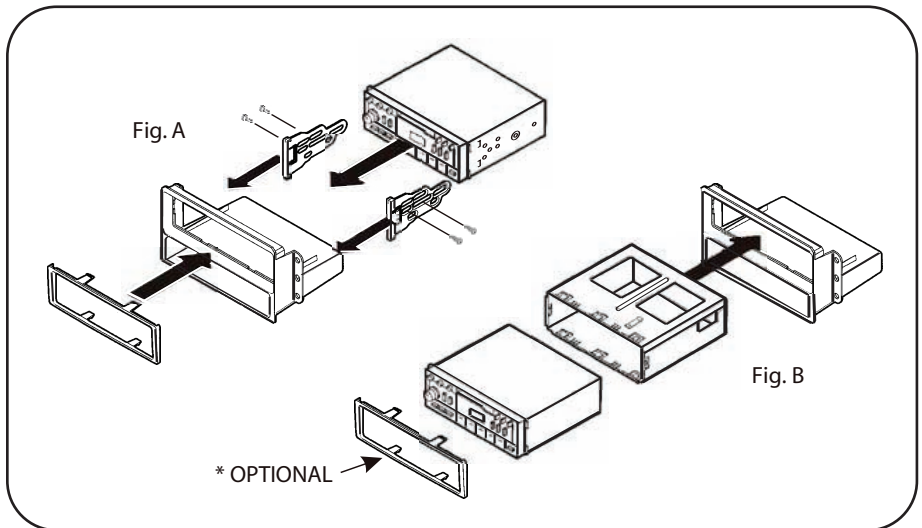

FINAL ASSEMBLY

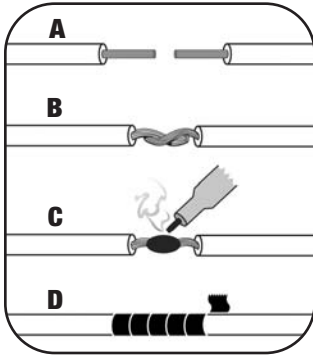

- (A) Strip wire ends back 1/2"**
- B) Twist ends together**
- C) Solder**
- D) Tape**

- 1** Locate the factory wiring harness in the dash. Metra recommends using the proper mating adapter and making connections as shown. (Isolate and individually tape off the ends of any unused wires to prevent electrical short circuit.)
- 2** Re-connect the negative battery terminal and test the unit for proper operation.
- 3** Reassemble radio and dash assemblies in reverse order of disassembly.

FINAL WIRING CONNECTIONS

Make wiring connections using the EIA color code chart shown below and the instructions included with the head unit. Metra recommends making connections as shown below; Strip, Splice, Solder, Tape. Isolate and individually tape off ends of any unused wires to prevent electrical short circuit.

METRA / EIA WIRING CODE

12V Ignition / Acc.	Red	Right Front (+)	Gray
12V Batt / Memory.	Yellow	Right Front (-).	Gray/ Black
Ground	Black*	Left Front (+)	White
Power Antenna.	Blue	Left Front (-).	White / Black
Amp Turn-On	Blue / White	Right Rear (+)	Violet
Amp Ground	Black / White	Right Rear (-).	Violet / Black
Illumination	Orange	Left Rear (+)	Green
Dimmer	Orange / White	Left Rear (-)	Green / Black

*NOTE: When a Black wire is not present, ground radio to vehicle chassis.
All colors may not be present on all leads due to manufacturer's specifications.

ALL VEHICLES

Locate the (4) mounting positions in the sub-dash ("A").

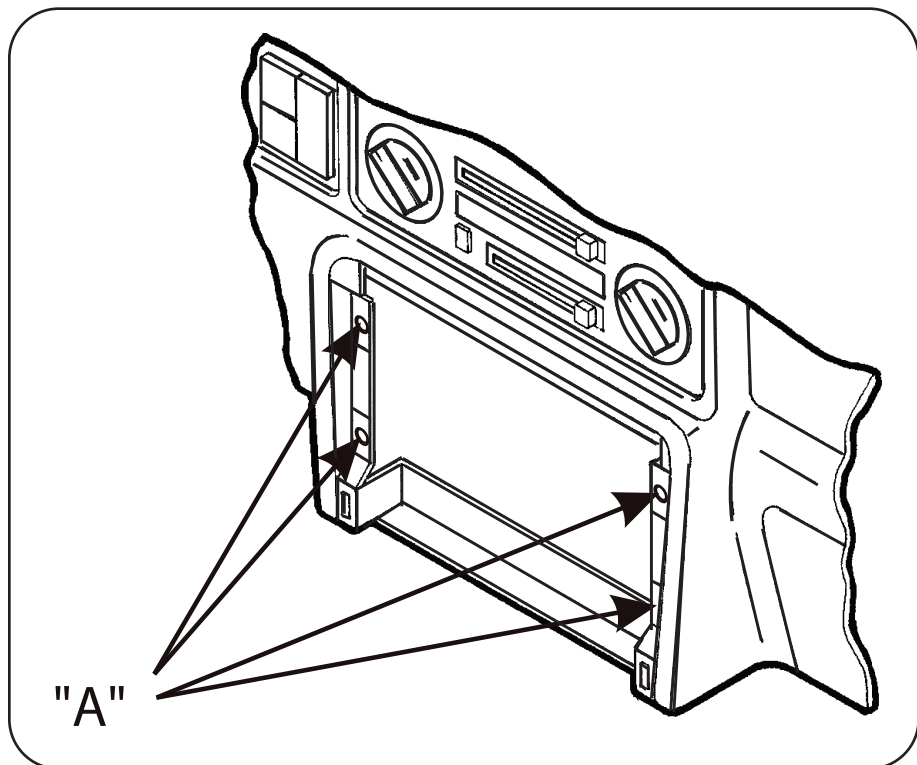

ALL VEHICLES

Re-connect the battery terminal and test the unit for proper operation. Mount the head unit/kit assembly to the sub-dash with (4) Phillips screws previously removed on page 1.

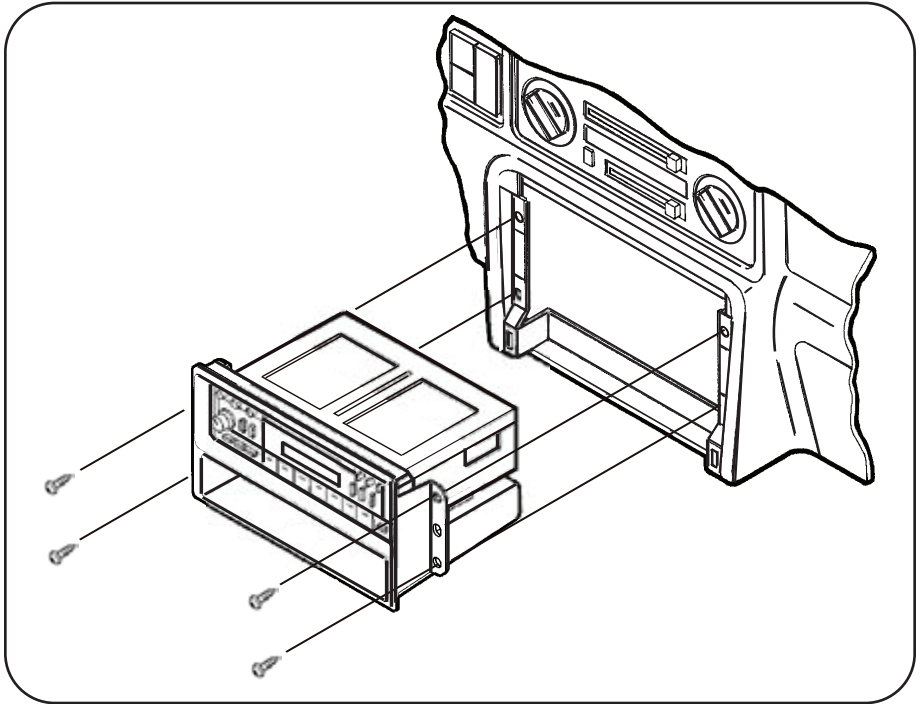

99-1004 INSTRUCTIONS



1-800-221-0932



www.metraonline.com

REV. 11/26/08 © COPYRIGHT 2001-2008 METRA ELECTRONICS CORPORATION INST99-1004