



### Buick Regal 2011-2012

Visit [MetraOnline.com](http://MetraOnline.com) for up-to-date vehicle specific applications.

#### KIT FEATURES

- ISO DIN Head unit provision with pocket
- DDIN Head unit provisions
- 99-2023B - Painted Black to match factory finish
- 99-2023BR - Painted Brown to match factory finish

#### TOOLS REQUIRED

- Panel removal tool • Phillips screwdriver • Socket Wrench

#### KIT COMPONENTS

- A) Radio Trim Panel • B) Radio Brackets • C) Pocket • D) Climate Control Trim Ring • E) Climate Control Trim Panel • F) Data Interface
- G) Interface Harness • H) (2) #8 x 3/8" Pan-head Phillips screws • I) (4) #8 x 3/8" Truss-head Phillips screws • J) Switch Blank Plate

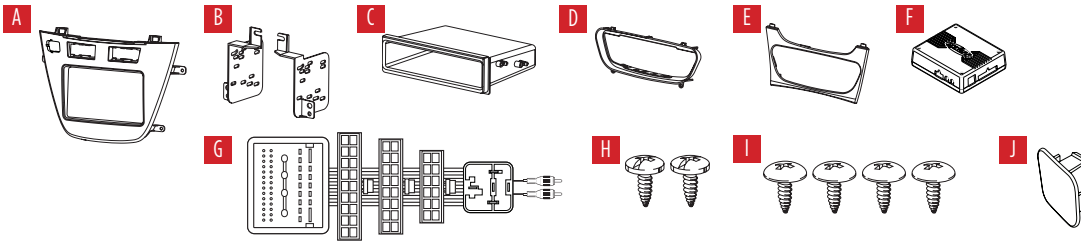

#### TABLE OF CONTENTS

Dash Disassembly .....	2
Radio Panel Assembly .....	3
Climate Control Panel Assembly .....	3
ISO DIN head unit provisions .....	4
DDIN head unit provisions .....	4
Axxess interface installation .....	5-7

#### WIRING & ANTENNA CONNECTIONS

Wiring Harness: • Included with kit  
 Antenna Adapter: • 40-EU55 - amplified antenna adapter (sold separately)

**ATTENTION:** With the key out of the ignition, disconnect the negative battery terminal before installing this product. Ensure that all installation connections, especially the air bag indicator lights, are plugged in before reconnecting the battery or cycling the ignition to test this product.  
**NOTE:** Refer also to the instructions included with the aftermarket radio.

## DASH DISASSEMBLY

1. Unsnap and remove the pocket/ashtray assembly. (Figure A)
2. Unsnap and remove the trim above the glove box. (Figure B)
3. Unsnap and remove the trim between the radio and steering wheel. (Figure C)

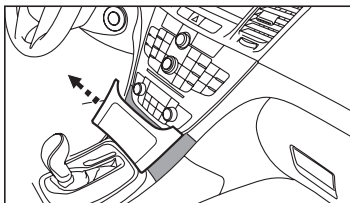

(Figure A)

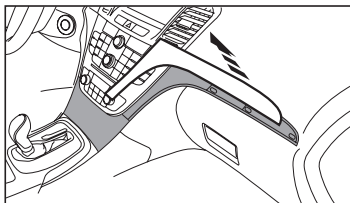

(Figure B)

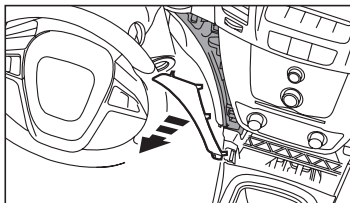

(Figure C)

4. Unsnap and remove the vent/ screen panel above the radio. (take caution not to cycle the key with this panel unplugged) (Figure D)
5. Remove four 7mm screws to remove radio face and climate controls. (Figure E)
6. Remove four 7mm screws to remove the radio chassis. (Figure F)

*Continue to Kit Assembly*

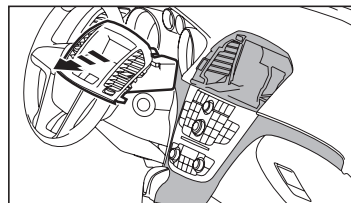

(Figure D)

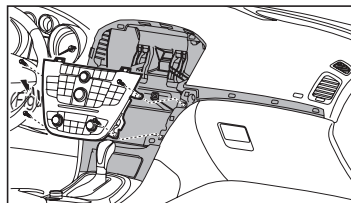

(Figure E)

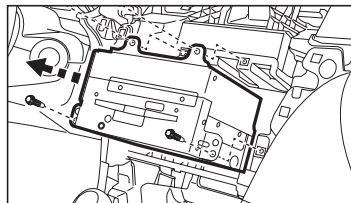

(Figure F)

## RADIO PANEL ASSEMBLY

1. Unsnap the climate controls, traction control switch, park assist switch and start/stop switch (if equipped) from the factory radio panel. (Figure A)
2. Snap the switches into the Metra kit panel.  
**Note:** If no start/stop switch is present use the supplied switch blank plate.

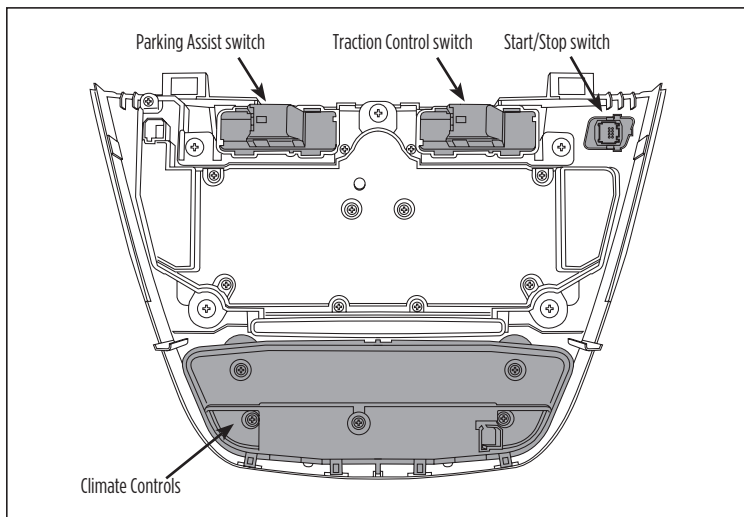

(Figure A)

## CLIMATE CONTROL PANEL ASSEMBLY

3. Snap the climate control in the climate control panel.  
**Note:** Minor sub dash modification may be necessary to allow for clearance of the climate control (See inset). (Figure B)

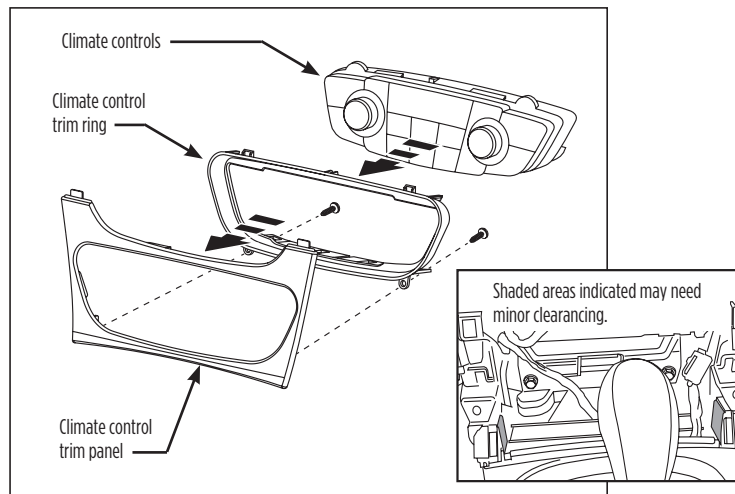

(Figure B)

## ISO DIN HEAD UNIT PROVISION WITH POCKET

1. Mount the radio to the brackets with the screws included with unit. (Figure A)
2. Mount the pocket to the radio brackets with the screws supplied. (Figure A)
3. Locate the factory wiring harness and antenna plug in the dash. Metra recommends using the proper mating adapters from Metra and/or AXXESS.
4. Mount assembly into the sub dash. (Figure B)
5. Reassemble dash in reverse order of disassembly using 99-2022 trim panel instead of factory panel.

*Continue to Interface Installation*

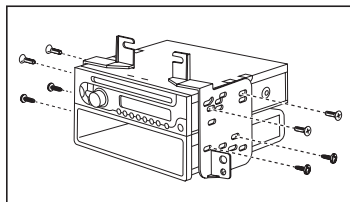

(Figure A)

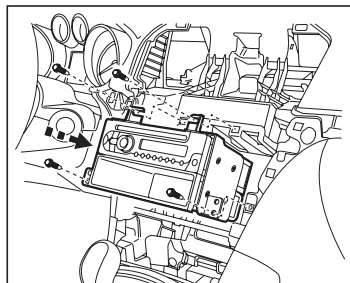

(Figure B)

## DOUBLE DIN HEAD UNIT PROVISIONS

1. Mount the radio to the DDIN brackets with screws included with unit. (Figure A)
2. Locate the factory wiring harness and antenna plug in the dash. Metra recommends using the proper mating adapters from Metra and/or AXXESS.
3. Mount assembly into the sub dash. (Figure B)
4. Reassemble dash in reverse order of disassembly using 99-2022 trim panel instead of factory panel.

*Continue to Interface Installation*

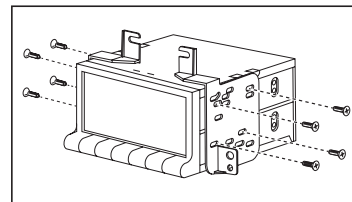

(Figure A)

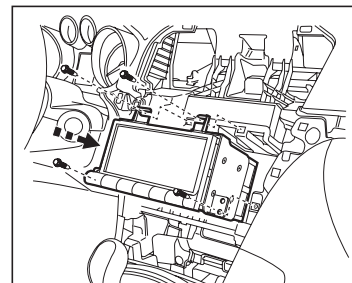

(Figure B)

# AXXESS INTERFACE INSTALLATION

## TABLE OF CONTENTS

---

Connections	
From 16-Pin Harness.....	6
From 16-Pin Harness with Nav .....	6
From 44-Pin Harness.....	6
From 18-Pin Harness.....	6
Adjustment Settings	
Chime Volume Adjustment .....	7
Onstar® Level Adjustment .....	7
Testing the Interface.....	7
12-Pin SWC Adjustment .....	7
Personalization Menu .....	7

## TOOLS REQUIRED

---

- Crimping tool and connectors, or solder gun, solder, and heat shrink
- Tape
- Female Spade Connectors (Optional)

**Important: Before beginning any of the following, disconnect the negative battery terminal to prevent an accidental short circuit.**

The included interface with this kit is designed to retain Onstar®, and retain factory warning chimes, and keep the factory climate display active. It also provides a 12-volt accessory output, mute, park brake, speed signal and reverse output.

## CONNECTIONS

### From the 16-pin harness, connect as indicated:

- **Red** wire to the ignition/accessory wire
- **Orange/White** wire to the illumination wire of the aftermarket radio  
If the aftermarket radio has no illumination wire just tape off the **Orange/White** wire
- **Blue/White** wire to the amp turn-on wire of the aftermarket radio
- **White** wire to the left front positive speaker output of the aftermarket radio
- **White/Black** wire to the left front negative speaker output of the aftermarket radio
- **Gray** wire to the right front positive speaker output of the aftermarket radio
- **Gray/Black** wire to the right front negative speaker output of the aftermarket radio
- **Green** wire to the left rear positive speaker output of the aftermarket radio
- **Green/Black** wire to the left rear negative speaker output of the aftermarket radio
- **Purple** wire to the right rear positive speaker output of the aftermarket radio
- **Purple/Black** wire to the right rear negative output of the aftermarket radio
- **Brown** wire to the mute wire of the aftermarket radio  
If the aftermarket radio does not have a Mute wire, tape up the **Brown** wire

### The following wires on the 16-pin harness are for the aftermarket radios with navigation built in. Connect as indicated:

- **Light Green** wire to the parking brake wire of the aftermarket navigation radio
- **Blue/Pink** wire to the VSS or speed sense wire of the aftermarket navigation radio
- **Green/Purple** wire to the reverse wire of the aftermarket navigation radio

### From the 44-pin harness, connect as indicated:

- **Yellow** wire to the 12-volt constant/battery wire of the aftermarket radio
- **Black** wire to the ground wire of the aftermarket radio
- The RCAs to the AUX input of your aftermarket radio

### From the 18-pin harness, connect as indicated:

- **Black** wire with the ring terminal to the radio chassis  
(This wire must be grounded here by itself for the interface to work properly)
- **Black/Yellow** wire and additional 12-pin harness will be discussed later in this manual
- Connect the RCAs to the AUX input of your aftermarket radio (if equipped)

# ADJUSTMENTS

## Chime Volume Adjustment

To adjust the chime volume, use a small screwdriver to rotate the potentiometer, located on the 16-pin harness side of the interface. Rotate *clockwise* to make the chime louder, and *counterclockwise* to make the chime softer.

## Onstar® Level Adjustment

To adjust the Onstar® volume level find the **Black/Yellow** wire on the 22-pin harness.

Push the blue Onstar® button, while the voice is speaking tap the **Black/Yellow** wire to ground.

There are 4 volume settings for Onstar®; once the 4th setting is reached and the **Black/Yellow** wire is tapped to ground it will automatically go back to the first volume setting.

Once the volume is set it will stay at that volume until the **Black/Yellow** wire is tapped to ground again.

This can be set during installation and then left alone.

If user adjustment is desired, the customer may also tap volume up or down to adjust the Onstar® level.

## Additional 12-pin harness Steering Wheel Control Interface (SWC)

- This 12-pin harness is to be used in conjunction with the SWC (not included). Please refer to the Steering Wheel Control Interface instructions for programming.

## Testing the Interface

1. Turn the ignition on, and then turn the aftermarket radio on.
2. Push the Onstar® button, the radio should turn off and you should hear Onstar®. Push the Onstar® cancel button and the radio should come back on.

## Personalization Menu

### **Note: Vehicle must have steering wheel controls from the factory**

1. Turn off your aftermarket radio.
2. Press and hold off hook for 3 seconds. After 3 seconds the personalization menu will show up on the display.
3. To scroll through the menu's use seek up and down
4. To make a selection, use the Source button which is the center button between seek up and down.
5. Use off hook to exit the personalization menu

**Note:** Personalization menu can be set before the factory radio is removed.



**99-2023**  
INSTALLATION INSTRUCTIONS



Having difficulties? We're here to help.



Contact our Tech Support line at:

**386-257-1187**



Or via email at:

[techsupport@metra-autosound.com](mailto:techsupport@metra-autosound.com)

**Tech Support Hours (Eastern Standard Time)**

Monday - Friday: 9:00 AM - 7:00 PM

Saturday: 10:00 AM - 5:00 PM

Sunday: 10:00 AM - 4:00 PM



**Metra recommends MECP  
certified technicians**