



Cadillac XLR 2004-2009

Visit MetraOnline.com for more detailed information about the product and up-to-date vehicle specific applications

KIT FEATURES

- ISO DIN radio provision with pocket
- ISO DDIN radio provision
- Complete center dash panel for a factory look
- Painted matte black
- Includes an Axxess interface, wiring harness, ASWC-1, and antenna adapter for a complete installation

KIT COMPONENTS

- A) Radio/climate control panel • B) Radio brackets • C) Climate control trim panel A (04-05) • D) Climate control trim panel B (06-09) • E) Pocket
- F) (6) Panel clips • G) (12) #8 x 3/8" Phillips screws • H) Axxess interface and wiring harness (not shown) • I) Antenna adapter (not shown)
- J) ASWC-1 (not shown)

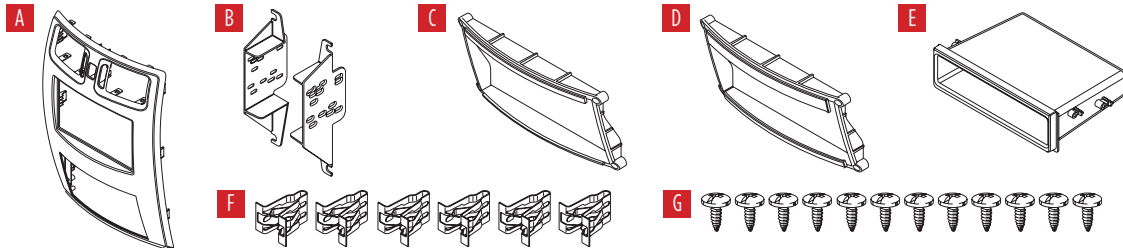

TABLE OF CONTENTS

Dash Disassembly	2-3
Kit Preparation	4-5
Kit Assembly	
–ISO DIN radio provision with pocket	6
–ISO DDIN radio provision.....	7
Axxess Interface Installation.....	8
Final Assembly.....	11

WIRING & ANTENNA CONNECTIONS

- Wiring Harness: Axxess interface included
- Antenna Adapter: Included with kit
- Steering wheel control interface: ASWC-1 included

TOOLS REQUIRED

- Panel removal tool • Phillips screwdriver
- 9/32" Socket wrench

Attention! Let the vehicle sit with the key out of the ignition for a few minutes before removing the factory radio. When testing the aftermarket equipment, ensure that all factory equipment is connected before cycling the key to ignition.

DASH DISASSEMBLY

1. On the bottom of the shifter, pull the chrome trim downward, and then remove (1) screw exposed. Pull up on the shifter to remove it. (Figure A)
2. Unclip the shifter trim plate, then set to the side. (Figure B)

Continued on the next page

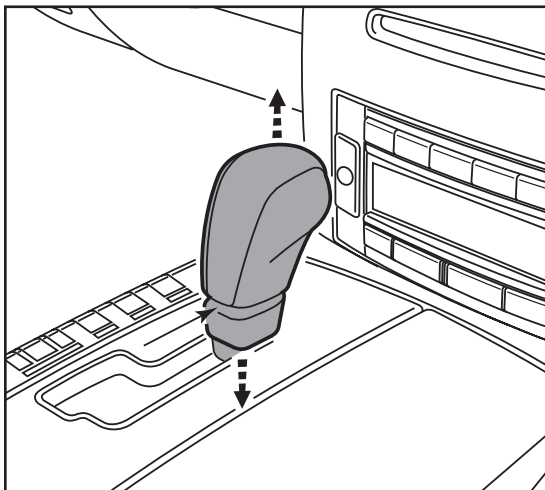

(Figure A)

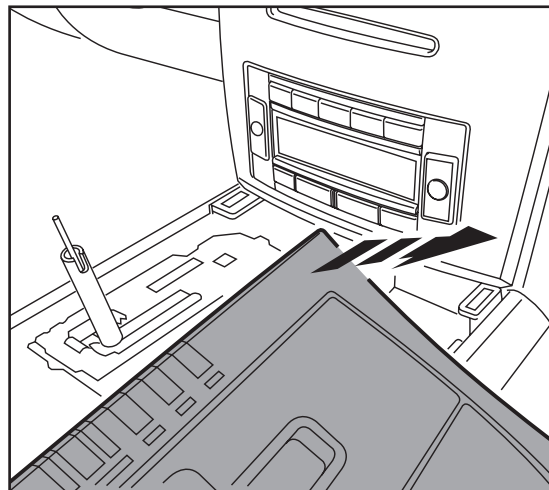

(Figure B)

DASH DISASSEMBLY (CONT.)

3. Unclip, unplug, and remove the radio/ climate control panel. (Figure C)
4. Remove (4) 9/32" screws securing the radio. Slide the radio out, then unplug and remove the radio. (Figure D)

Continue to Kit Preparation

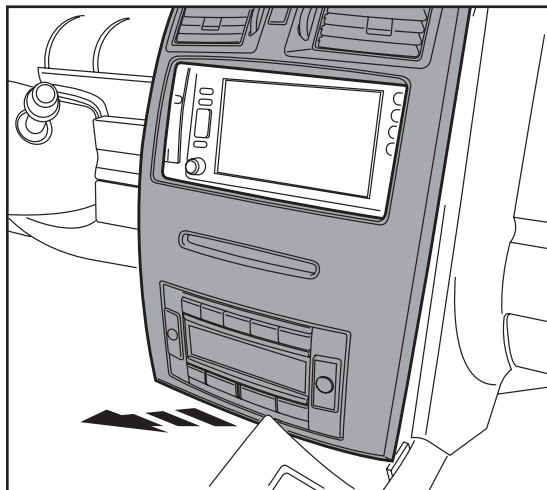

(Figure C)

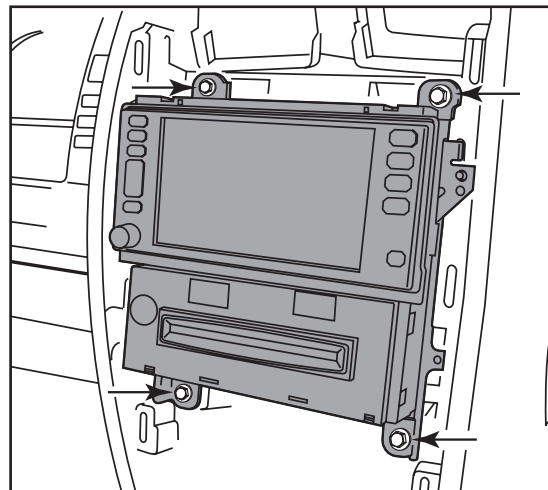

(Figure D)

KIT PREPARATION

From the factory radio/climate control panel:

1. Unclip and remove the a/c vents.
(Figure A)
2. Unclip and remove the hazard switch.
(Figure A)
3. Remove (4) screws securing the climate controls, then remove the controls.
(Figure A)

Continued on the next page

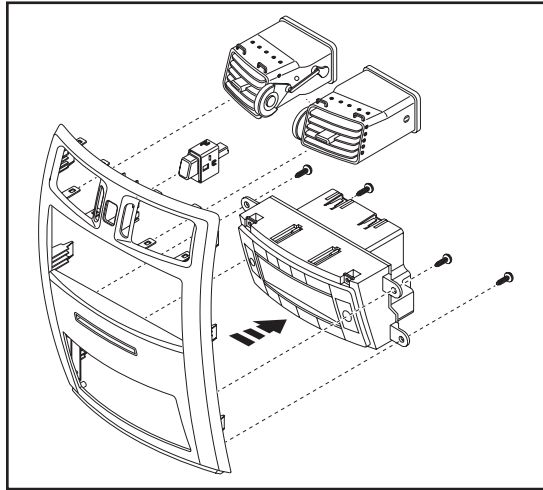

(Figure A)

KIT PREPARATION (CONT.)

- Secure the appropriate **climate control trim panel** to the **99-3030B radio/ climate control panel** using the (4) #8 x 3/8" Phillips screws provided. The **climate control panel** part number is stamped onto the back of the panel.

CH-3030-1 - 2004-2005

CH-3030-2 - 2006-2009 (Figure A)

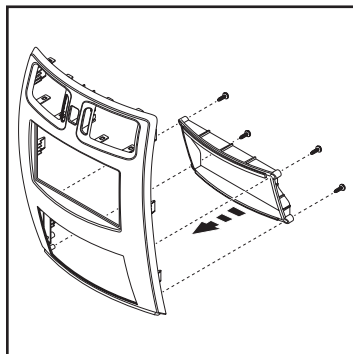

(Figure A)

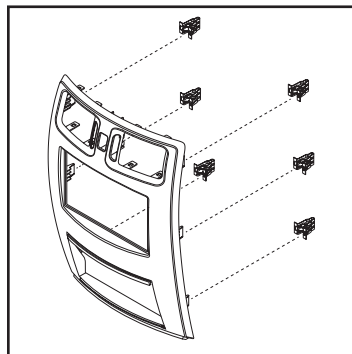

(Figure B)

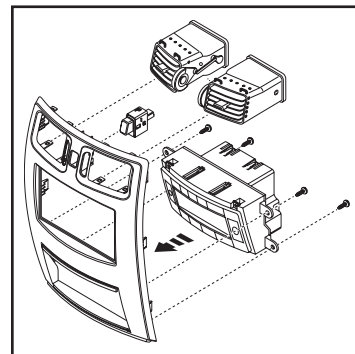

(Figure C)

To the 99-3030B radio/climate control panel:

- Secure the (6) **panel clips** supplied to the panel (the factory clips can also be used if so desired). (Figure B)
- Clip in the factory a/c vents. (Figure C)
- Clip in the hazard switch. (Figure C)
- Secure the climate controls to the panel using the (4) #8 x 3/8" Phillips screws provided. (Figure C)

Continue to Kit Assembly

KIT ASSEMBLY

ISO DIN radio provision with pocket

1. Secure the **radio brackets** to the **pocket** using the (4) #8 x 3/8" Phillips screws provided. (Figure A)
2. Remove the metal DIN sleeve and trim ring from the aftermarket radio.
3. Slide the radio into the bracket/pocket assembly, then secure it to the assembly using the screws supplied with the radio. (Figure B)

Continue to Axxess Interface Installation

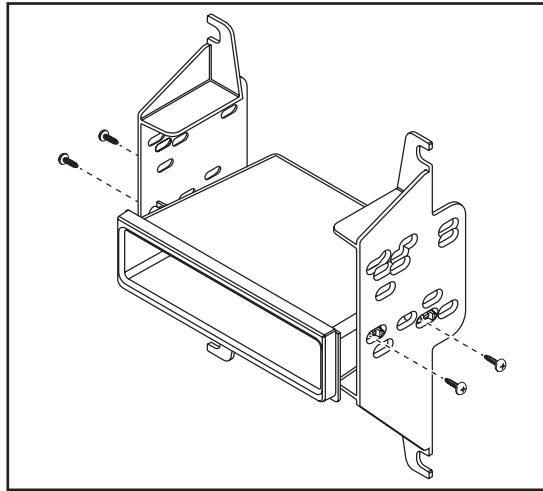

(Figure A)

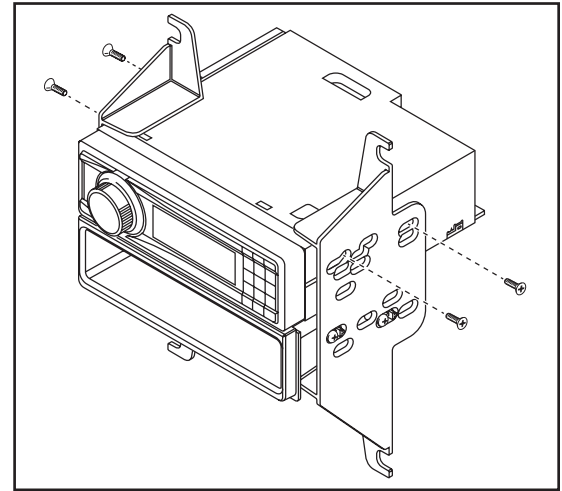

(Figure B)

KIT ASSEMBLY

ISO DDIN radio provision

1. Secure the **radio brackets** to the radio using the screws supplied with the radio. (Figure A)

Continue to Axxess Interface Installation

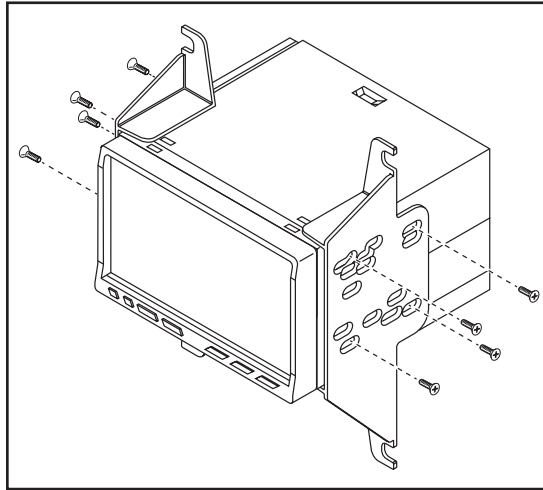

(Figure A)

AXXESS INTERFACE INSTALLATION

INTERFACE FEATURES

- Provides accessory power (12-volt 10-amp)
- Maintains the Retained Accessory Power (R.A.P.) feature
- Provides NAV outputs (parking brake, reverse, speed sense)
- Retains warning chimes
- Retains OnStar/OE Bluetooth
- Adjustable volume for chimes and OnStar
- Retains steering wheel controls via ASWC-1
- Retains the factory amplifier
- Retains balance and fade
- Micro-B USB updatable

INTERFACE COMPONENTS

- Axxess interface
- 3030 harness
- 16-pin harness with stripped leads
- ASWC-1 harness
- ASWC-1 interface
- CD player jumper harness
- Female 3.5mm connector with stripped leads

TABLE OF CONTENTS

Connections	9-12
Installation	13
Programming	13
Adjustments.....	14

TOOLS REQUIRED

- Crimping tool and connectors, or solder gun, solder, and heat shrink
- Small flat blade screwdriver • Tape • Wire cutter • Zip ties

CONNECTIONS

From the 16-pin harness with stripped leads to the aftermarket radio:

- Connect the **Red** wire to the accessory wire.
Note: There will be a **Red** wire from the **3030 harness** to connect as well.
- Connect the **Blue/White** wire to the amp turn on wire. This wire must be connected to hear sound from the factory amplifier.
- If the aftermarket radio has a mute wire, connect the **Brown** wire to it. If the mute wire is not connected, the radio will turn off when OnStar is activated.
- Connect the **Gray** wire to the right front positive speaker output.
- Connect the **Gray/Black** wire to the right front negative speaker output.
- Connect the **White** wire to the left front positive speaker output.
- Connect the **White/Black** wire to the left front negative speaker output.
- Connect the **Green** wire to the left rear positive speaker output.
- Connect the **Green/Black** wire to the left rear negative speaker output.
- Connect the **Purple** wire to the right rear positive speaker output.
- Connect the **Purple/Black** wire to the right rear negative speaker output.

The following (3) wires are only for multimedia/navigation radios that require these wires.

- Connect the **Blue/Pink** wire to the VSS/speed sense wire.
- Connect the **Green/Purple** wire to the reverse wire.
- Connect the **Light Green** wire to the parking brake wire.
- Tape off and disregard the **Orange/White** wire, it will not be used in this application.

From the 3030 harness to the aftermarket radio:

- Connect the **Black** wire, and the (3) **Black/White** wires to the ground wire.
- Connect the **Yellow** wire to the battery wire.
- Connect the **Blue** wire to the power antenna wire.
- If the aftermarket radio has an illumination wire, connect the **Orange** wire to it.
- The **Black/Yellow** wire is used for OnStar level adjustment for models that do not come equipped with steering wheel controls. Refer to the **Onstar level adjustment** section for further instructions.

ASWC-1 harness:

This harness is to be used along with the ASWC-1 to retain steering wheel audio controls. Refer to the ASWC-1 vehicle specific install instructions available at axxessinterfaces.com for radio connections and programming.

- Connect the **Red** wire to accessory power.

Continue to Installation

INSTALLATION

With the key in the off position:

1. Connect the **CD player jumper harness** to the wiring harness in the vehicle.
2. Connect the **ASWC-1 harness** to the wiring harness in the vehicle. Do not connect the **ASWC-1** until the **Axxess interface** is programmed and fully functional.
3. Connect the **16-pin harness with stripped leads** into the **Axxess interface**.
4. Connect the **3030 harness** into the **Axxess interface**, and then to the wiring harness in the vehicle.
5. Locate the factory antenna connector in the dash and complete all necessary connections to the radio. Use the antenna adapter provided to adapt the factory antenna connector to the aftermarket radio.

PROGRAMMING

Attention! If the interface ever loses power, the following steps will need to be performed again. Please ensure that the owner of the vehicle knows this.

1. Temporarily connect the climate control while programming.
2. Turn the key to the ignition position and wait until the radio comes on.
Note: If the radio doesn't come on within 60 seconds, turn the key to the off position, disconnect the interface, check all connections, reconnect the interface and then try again.
3. Cycle the key off. If the driver's door is closed, open and close the door. Cycle the key back on.
4. Test all functions of the installation for proper operation, before reassembling the dash.
5. Connect the **ASWC-1** to the **ASWC-1 harness**, then program it per the vehicle specific install instructions.

ADJUSTMENTS

Audio level adjustment:

1. With the vehicle and radio turned on, turn the volume up 3/4 of the way.
2. With a small flat-blade screwdriver, adjust the potentiometer clockwise to raise the audio level; counterclockwise to lower the audio level.
3. Once at a desired level, audio level adjustment is complete.

Chime level adjustment:

1. With the vehicle on, turn it off and leave the keys in ignition. Open the driver's door; chimes will be heard.
2. Wait 10 seconds, and then with a small flat-blade screwdriver, turn the potentiometer clockwise to raise the chime level; counterclockwise to lower the chime level.
3. When the chime is at a desired level, remove the keys from the ignition. This will lock the chime volume at its current level.

OnStar level adjustment:

1. Press the OnStar button to activate it.
2. While OnStar is speaking, press the VOLUME-UP or VOLUME-DOWN button on the steering wheel to raise or lower the OnStar level.
3. If the vehicle doesn't come equipped with steering wheel controls, locate the **Black/Yellow** wire on the **3030 harness**.
4. While OnStar is speaking, tap the **Black/Yellow** wire to ground. Once the OnStar level is set, it will stay at that level until the **Black/Yellow** wire is tapped to ground again.

FINAL ASSEMBLY

1. Secure the radio assembly to the dash using the factory screws.
2. Reassemble the dash in reverse order of disassembly using the **99-3030 radio trim panel** to complete the installation.



99-3030B
INSTALLATION INSTRUCTIONS



If you are having difficulties with the installation of this product, contact our Tech Support line either by phone at **1-800-253-TECH**, or email at **techsupport@metra-autosound.com**. Before doing so, look over the instruction booklet a second time and ensure that the installation was performed exactly as the instruction booklet is stated. Have the vehicle apart and ready to perform troubleshooting steps before contacting Metra/Axxess Tech Support.



KNOWLEDGE IS POWER

Enhance your installation and fabrication skills by enrolling in the most recognized and respected mobile electronics school in our industry. Log onto www.installerinstitute.com or call 800-354-6782 for more information and take steps toward a better tomorrow.



Metra recommends MECP certified technicians