



## Lincoln Navigator 2007-2014 / MKX 2007-2010 Lincoln MKZ 2007-2009 / Zephyr 2006

(excludes models equipped with factory navigation)

### KIT FEATURES

- DIN radio provision with pocket
- ISO DIN radio provision with pocket

### KIT COMPONENTS

- A) Radio housing • B) ISO brackets • C) Trim plate • D) Radio housing brackets (MKZ and Zephyr) • E) (4) #8 3/8" Phillips screws

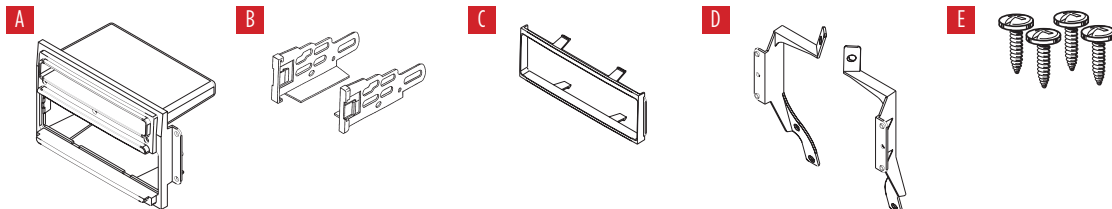

### TABLE OF CONTENTS

Dash Disassembly	
–Navigator 2007-2014 .....	2
–MKX 2007-2010 .....	3
–MKZ 2007-2009 / Zephyr 2006 .....	4
Kit Assembly	
–DIN radio provision with pocket .....	5
–ISO DIN radio provision with pocket .....	6

### WIRING & ANTENNA CONNECTIONS (sold separately)

Wiring Harness: Please visit [metraonline.com](http://metraonline.com) for wiring harness options

Antenna Adapter: 40-CR10

Steering Wheel Control Interface: ASWC-1

### TOOLS REQUIRED

- Panel removal tool • Phillips screwdriver
- 10mm socket wrench • 9/32" socket wrench

**CAUTION!** All accessories, switches, climate controls panels, and especially air bag indicator lights must be connected before cycling the ignition. Also, do not remove the factory radio with the key in the on position, or while the vehicle is running.

## DASH DISASSEMBLY

### Navigator 2007-2014

1. Unclip and remove the panel surrounding the shifter. (Figure A)
2. Remove (2) 9/32" screws from the bottom of the radio/climate control trim panel. (Figure B)
3. Unclip and remove the entire panel surrounding the radio and including the climate controls. (Figure B)
4. Remove (4) 9/32" screws securing the radio. Unplug and remove the radio. (Figure C)

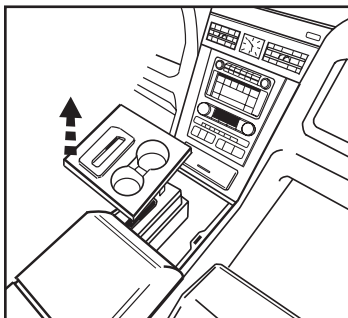

(Figure A)

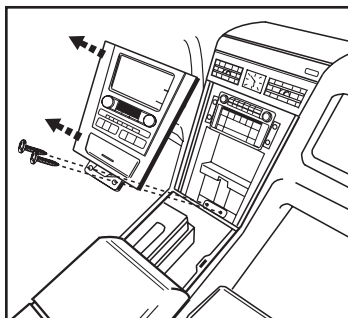

(Figure B)

*Continue to Kit Assembly*

## DASH DISASSEMBLY

### MKX 2007-2010

1. Open center console lid and unclip and remove the center console trim panel surrounding the shifter. (Figure A)
2. Remove (2) 9/32" screws from the storage bin then unclip and remove the bin. (Figure B)
3. Unclip and remove the center trim panel as one assembly. (Figure C)
4. Remove (4) 9/32" screws securing the radio. Unplug and remove the radio.

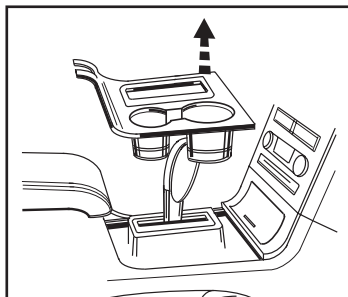

(Figure A)

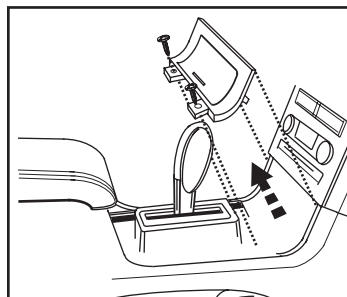

(Figure B)

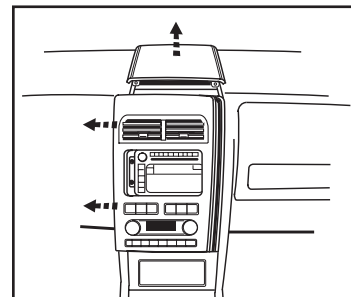

(Figure C)

*Continue to Kit Assembly*

## DASH DISASSEMBLY

### MKZ 2007-2009 / Zephyr 2006

1. Unclip and remove the top of the center console. (Figure A)
2. Open ashtray door and remove ashtray then remove (1) Phillips screw from inside ashtray cavity. Close ashtray door.
3. Unclip and remove the climate control and trim panel assembly starting at the bottom edge. (Figure B)
4. Open the climate control vents and pull straight outward to remove. (Figure C)

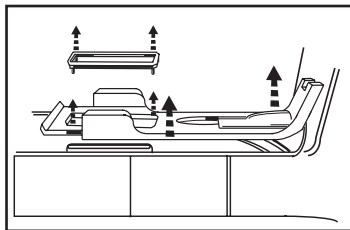

(Figure A)

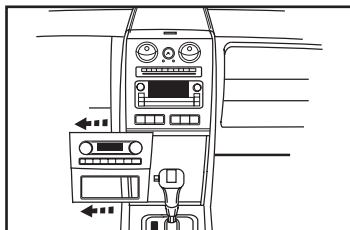

(Figure B)

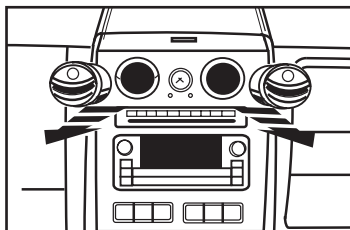

(Figure C)

5. Release the (3) clips securing the inner vent cups then pull out to remove cups. (Figure D)
6. Remove (2) 10mm screws from the bottom of the radio trim panel assembly and (2) 10mm screws from inside the vents. (Figure E)
7. Unclip the radio trim panel/radio assembly. Unplug and remove assembly. (Figure E)
8. Remove (4) Phillips screws securing the radio to the trim panel and remove the radio. (Figure F)

*Continue to Kit Assembly*

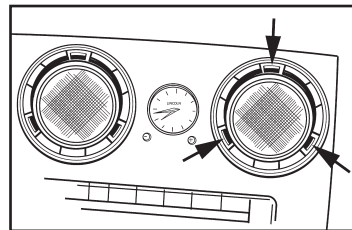

(Figure D)

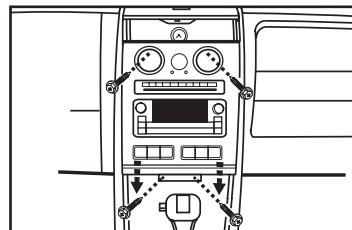

(Figure E)

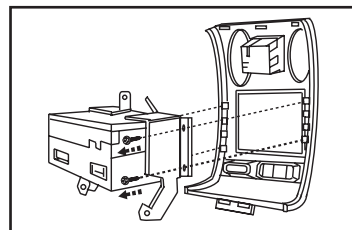

(Figure F)

## KIT ASSEMBLY

### DIN radio provision with pocket

- 1. MKZ 2007 and Zephyr 2006 only:**  
Attach the corresponding *radio housing bracket* to the 99-5813 *radio housing* using the (4) 8X3/8" Phillips screws supplied with kit. (All other models skip to step 2) (Figure A)
- 2.** Remove the metal DIN sleeve and trim ring from the aftermarket radio.
- 3.** Slide the sleeve into the *radio housing* and secure by bending the metal locking outward. (Figure B)
- 4.** Slide the radio back into the sleeve until it snaps into place. (Figure C)

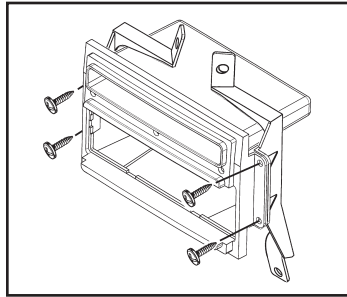

(Figure A)

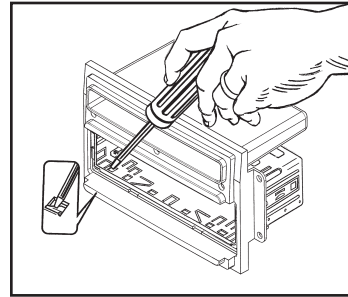

(Figure B)

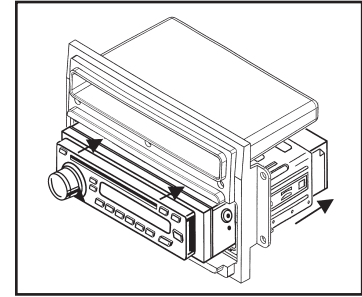

(Figure C)

## KIT ASSEMBLY

### ISO DIN radio provision with pocket

- 1. MKZ 2007 and Zephyr 2006 only:**  
Attach the corresponding *radio housing bracket* to the 99-5813 *radio housing* using the (4) 8X3/8" Phillips screws supplied with kit. (All other models skip to step 2) (Figure A)
- 2.** Remove the metal DIN sleeve and trim ring from the aftermarket radio.
- 3.** Secure the *ISO Brackets* to the radio using the screws supplied with the radio. (Figure B)
- 4.** Slide the radio into the *radio housing* until the side clips snap into place. (Figure C)
- 5.** Snap the *trim plate* onto the front of the radio housing. (Figure C)

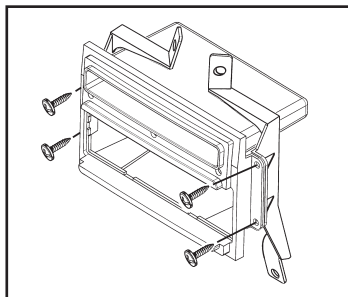

(Figure A)

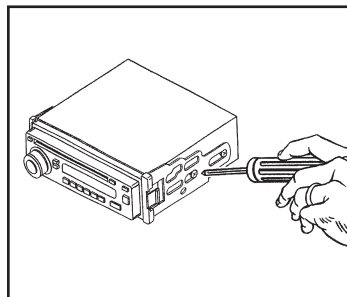

(Figure B)

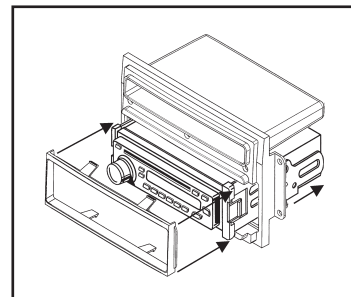

(Figure C)





**99-5813**  
INSTALLATION INSTRUCTIONS



**IMPORTANT**

*If you are having difficulties with the installation of this product, please call our Tech Support line at 1-800-253-TECH. Before doing so, look over the instructions a second time, and make sure the installation was performed exactly as the instructions are stated. Please have the vehicle apart and ready to perform troubleshooting steps before calling.*



**KNOWLEDGE IS POWER**

Enhance your installation and fabrication skills by enrolling in the most recognized and respected mobile electronics school in our industry. Log onto [www.installerinstitute.com](http://www.installerinstitute.com) or call 800-354-6782 for more information and take steps toward a better tomorrow.



**Metra recommends MECP certified technicians**