



Installation instructions for part 99-7808B

## Acura TL 2009-2014

(Factory navigation is no longer operational with the use of this kit)

### 99-7808B

#### KIT FEATURES

- ISO DIN radio provision with pocket
- Double DIN radio provision
- **Painted to match factory finish**



#### KIT COMPONENTS

- A) Radio trim panel • B) Radio brackets • C) Pocket • D) (8) #8 x 3/8" Phillips screws

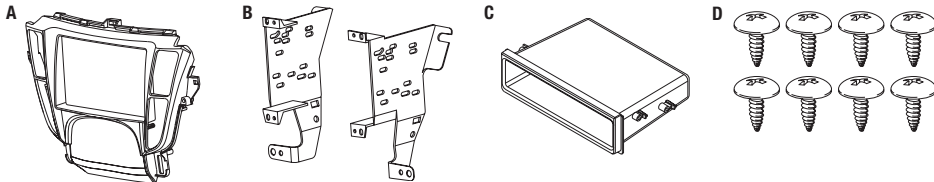

#### WIRING & ANTENNA CONNECTIONS (sold separately)

Wiring Harness: • 70-1729

Antenna Adapter: • 40-HD11 (without OE nav) • 40-HD12 (with OE nav)

#### Table of Contents

##### Dash Disassembly

– Acura TL 2009-2014 ..... 2

##### Kit Assembly

– ISO DIN radio provision with pocket..... 3

– Double DIN radio provision ..... 3

#### TOOLS REQUIRED

- Phillips screwdriver • Panel removal tool

**CAUTION:** Metra recommends disconnecting the negative battery terminal before beginning any installation. All accessories, switches, and especially air bag indicator lights must be plugged in before reconnecting the battery or cycling the ignition.

**NOTE:** Refer to the instructions included with the aftermarket radio.

REV. 4/14/2015 INST99-7808B

## Dash Disassembly

1. Unclip and remove the (2) side panels that extend along the center console and up along the sides of the factory radio. (Figure A)
2. Unclip and remove the a/c vent panel above the factory radio. (Figure B)

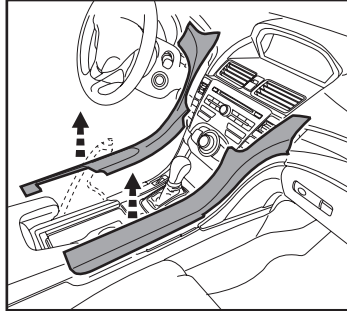

(Figure A)

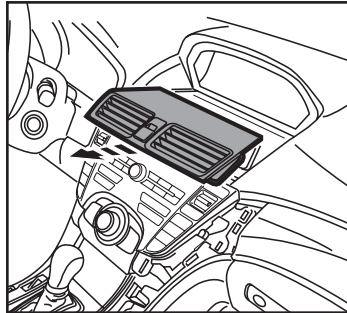

(Figure B)

3. Remove (4) 8 mm screws securing the factory radio. (Figure C)
4. Remove (3) Phillips screws from each a/c button pod then unclip and remove the pods from the factory radio panel assembly. (Figure D)

*Continue to kit assembly*

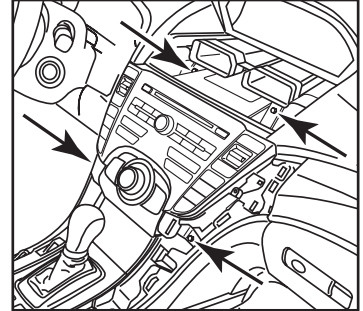

(Figure C)

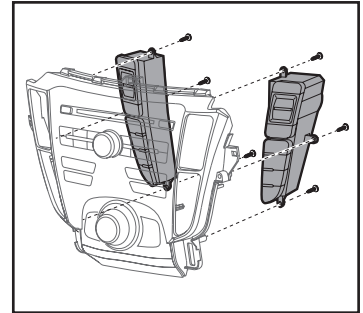

(Figure D)

## Kit Assembly

### ISO DIN radio provision with pocket

1. Attach the (2) a/c button pods to the radio trim panel using the factory hardware. (Figure A)
2. Attach the radio brackets to the radio trim panel using the (4) #8 x 3/8" Phillips screws supplied. (Figure B)
3. Mount the pocket to the bracket/panel assembly with the (4) #8 x 3/8" Phillips screws supplied. (Figure C)
4. Remove the metal "DIN" sleeve and trim ring from the aftermarket radio.
5. Slide the radio into the assembly and secure with screws supplied with the radio. (Figure C)
6. Locate the factory wiring harness and antenna plug in the dash and make all necessary connections to the radio. Metra recommends using the proper mating adapters from Metra and/or AXXESS.
7. Mount the new radio assembly into the dash and reassemble dash in reverse order of disassembly.

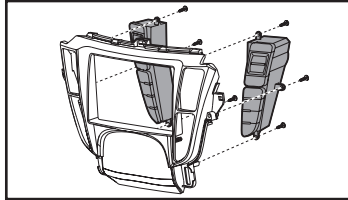

(Figure A)

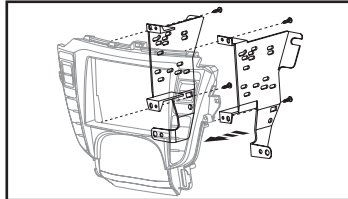

(Figure B)

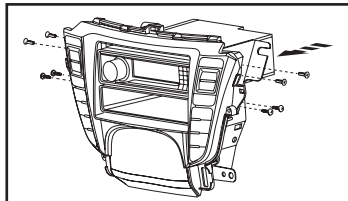

(Figure C)

### Double DIN radio provision

1. Attach the (2) a/c button pods to the radio trim panel using the factory hardware. (Figure A)
2. Attach the radio brackets to the radio trim panel using the (4) #8 x 3/8" Phillips screws supplied. (Figure B)
3. Slide the radio into the assembly and secure with screws supplied with the radio. (Figure C)
4. Locate the factory wiring harness and antenna plug in the dash and make all necessary connections to the radio. Metra recommends using the proper mating adapters from Metra and/or AXXESS.
5. Mount the new radio assembly into the dash and reassemble dash in reverse order of disassembly.

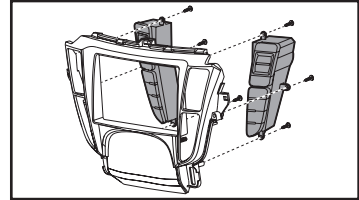

(Figure A)

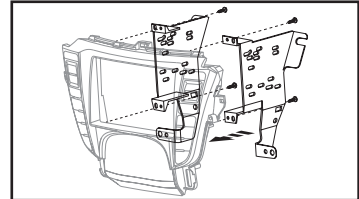

(Figure B)

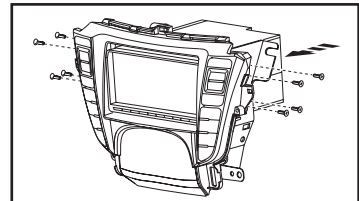

(Figure C)



Installation instructions for part 99-7808B



REV. 4/14/2015 INST99-7808B



### KNOWLEDGE IS POWER

Enhance your installation and fabrication skills by enrolling in the most recognized and respected mobile electronics school in our industry. Log onto [www.installerinstitute.com](http://www.installerinstitute.com) or call 800-354-6782 for more information and take steps toward a better tomorrow.



**Metra recommends MECP  
certified technicians**