



## INSTALLATION INSTRUCTIONS FOR PART 99-9303

### APPLICATIONS

# BMW Z4

## 2003-2008

# 99-9303



#### KIT FEATURES

- DIN Head Unit Provision

#### KIT COMPONENTS

A) Radio Housing

#### TOOLS REQUIRED:

- Small Flat Blade Screwdriver
- Phillips Screwdriver

A

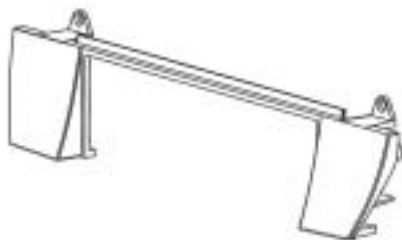

#### WIRING AND ANTENNA CONNECTIONS (Sold Separately)

- 40-EU10 - European antenna adapter
- 70-9003 - European harness

#### TABLE OF CONTENTS

Dash Disassembly: pg. 1  
Kit Assembly: pg. 2  
Final Assembly: pg. 3



1-800-221-0932



[www.metraonline.com](http://www.metraonline.com)

### BMW Z4 2003-2008

- 1 Disconnect the negative battery terminal to prevent an accidental short circuit.

**NOTE:** Make sure the vent on/off dials are in the middle position.

- 2 Using a small flat blade screwdriver, release the metal clip located inside the vents facing upward on the left and right side while pulling the vents outward from the dash. (Figure A)

- 3 Remove (2) Phillips screws exposed at top of radio and remove. (Figure B)

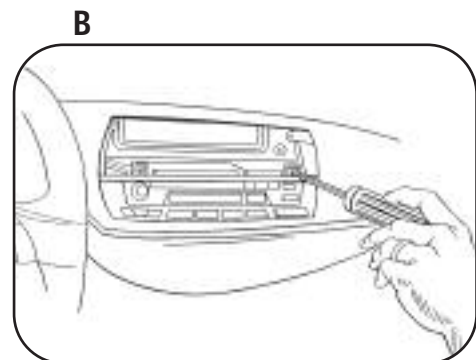
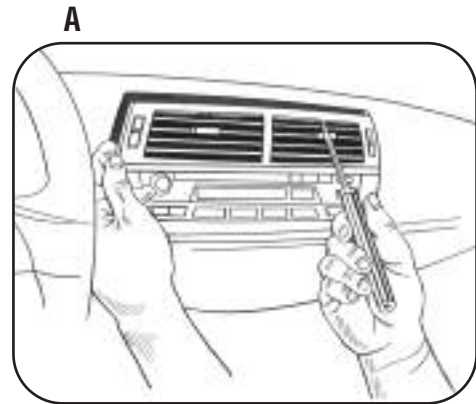

# 99-9303

## DIN HEAD UNIT PROVISION

**NOTE:**

The bottom bar connecting the two sides of the 99-9303 will need to be cut and removed prior to Kit Assembly. (Figure A)

- 1 Screw the 99-9303 housing into the dash opening instead of the factory radio. (Figure B)
- 2 Slide the DIN cage into the space in the 99-9303 and secure by bending the metal locking tabs outward. (Figure C)
- 3 Slide the aftermarket head unit into the DIN cage until secure. (Figure D)

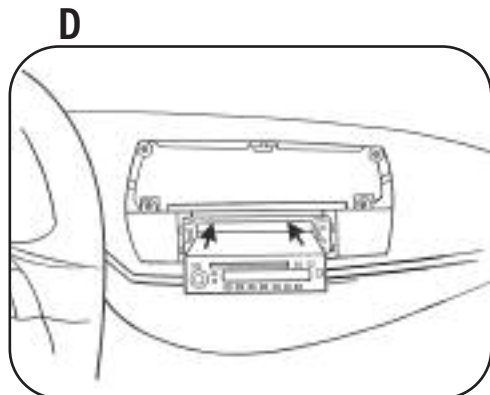
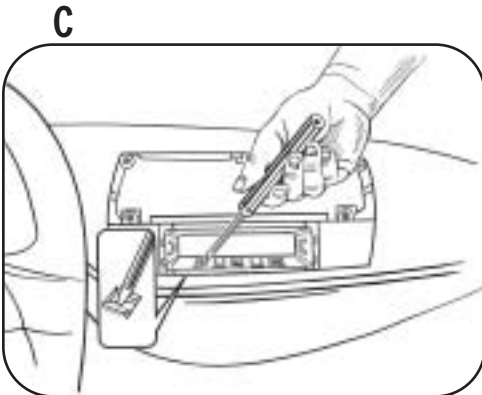
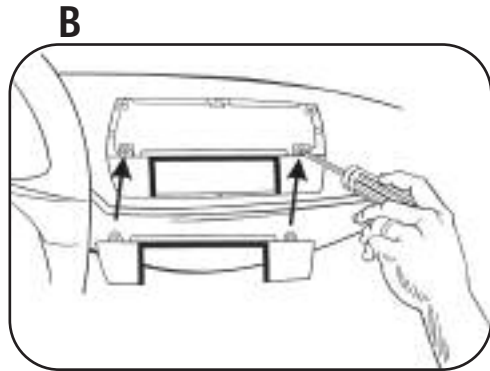
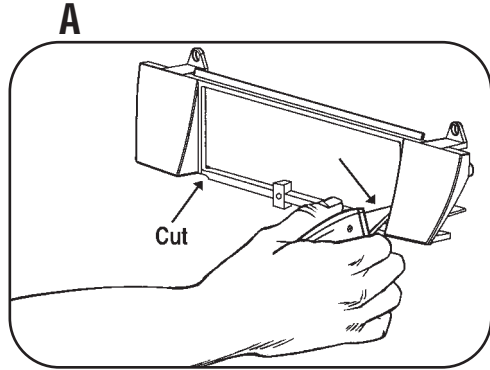

KIT ASSEMBLY



# 99-9303

## FINAL ASSEMBLY

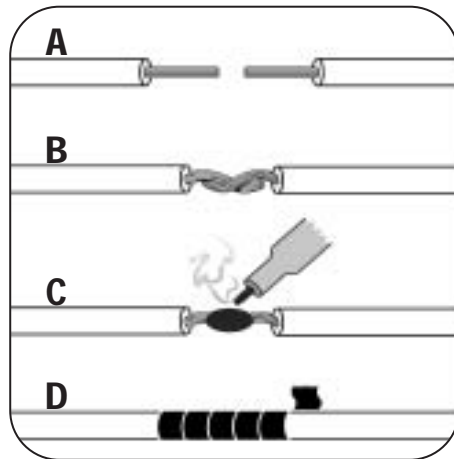

- A) *Strip wire ends back 1/2"*
- B) *Twist ends together*
- C) *Solder*
- D) *Tape*

- 1 Locate the factory wiring harness in the dash. Metra recommends using the proper mating adapter and making the connections as shown. (Isolate and individually tape off the ends of any unused wires to prevent electrical short circuit)
- 2 Re-connect the negative battery terminal and test the unit for proper operation.
- 3 Reassemble radio and dash assemblies in reverse order of disassembly.



### KNOWLEDGE IS POWER

Enhance your installation and fabrication skills by enrolling in the most recognized and respected mobile electronics school in our industry. Log onto [www.installerinstitute.com](http://www.installerinstitute.com) or call 800-354-6782 for more information and take steps toward a better tomorrow.