



## INSTALLATION INSTRUCTIONS FOR PART 99-9501

### **APPLICATIONS** **JAGUAR S-TYPE** **2003-2008** **JAGUAR X-TYPE** **2002-2008** **(NON-NAV MODELS)**

# **99-9501B** **99-9501G**

#### **KIT FEATURES**

- DIN Head Unit Provision w/ removable pocket
- ISO DIN Head Unit Provision w/ removable pocket
- DDIN Head Unit Provision
- ISO Stacked Head Unit Provision
- TWO FINISHES AVAILABLE:  
99-9501B=BLACK, 99-9501G=GREY



#### **KIT COMPONENTS**

- A) Radio Housing B) ISO Brackets C) ISO Trim Plate D) DDIN Brackets E) DDIN Trim Plate  
F) Pocket G) (2) Pocket C-Clips H) (2) Small Phillips screws

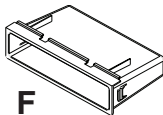
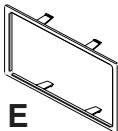
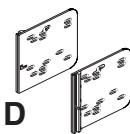
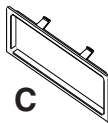
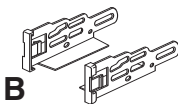
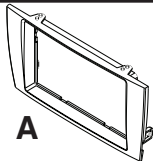

#### **TOOLS REQUIRED:**

- Small Flat Blade Screwdriver
- Torx Screwdriver
- Socket Wrench
- Cutting Tool



**METRA. THE WORLD'S BEST KITS.™**



**1-800-221-0932**



**www.metraonline.com**

© COPYRIGHT 2007-2009 METRA ELECTRONICS CORPORATION

## **TABLE OF CONTENTS**

### **Dash Disassembly**

- **Jaguar S-Type 2003-2008 . . . . . 1,2**
- **Jaguar X-Type 2002-2008 . . . . . 3,4**

### **Kit Preparation**

- **Jaguar S-Type 2003-2008 . . . . . 5**
- **Jaguar X-Type 2002-2008 . . . . . 5**

### **Kit Assembly**

- **DIN Head Unit Provision. . . . . 6**
- **ISO DIN Head Unit Provision. . . . . 7**
- **DDIN Head Unit Provision. . . . . 8**

**\*Note:**

**Refer also to the instructions included with the aftermarket radio.**



### **KNOWLEDGE IS POWER**

Enhance your installation and fabrication skills by enrolling in the most recognized and respected mobile electronics school in our industry. Log onto [www.installerinstitute.com](http://www.installerinstitute.com) or call 800-354-6782 for more information and take steps toward a better tomorrow.



Metra recommends MECP certified technicians.

**JAGUAR S-TYPE 2003-2008****NON-NAV MODELS**

- 1** Disconnect the negative battery terminal to prevent an accidental short circuit.
- 2** Remove cup holder and (2) screws securing center console storage compartment and remove compartment. (Figure A)
- 3** Unclip and remove the trim panel around the shifter. (Figure B)

*Continued on page 2*

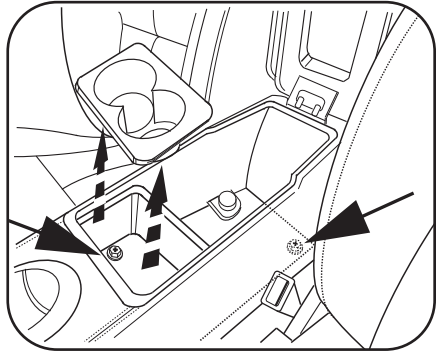
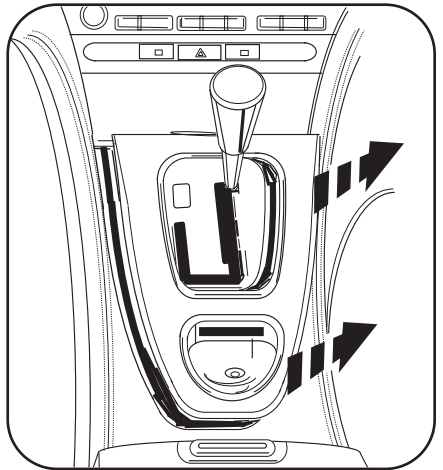
**A****B**

**JAGUAR S-TYPE 2003-2008**
**NON-NAV MODELS**

**4** Unclip and remove the trim panel surrounding the radio/climate controls/ashtray and front half of the center console. (Figure C)

**5** Remove (4) screws securing the radio/climate control assembly to the dash. Unplug and remove assembly. (Figure D)

**6** Remove (4) screws securing the radio to the assembly and remove the radio. Retain the assembly for re-use during kit assembly.

*Continue to kit assembly*

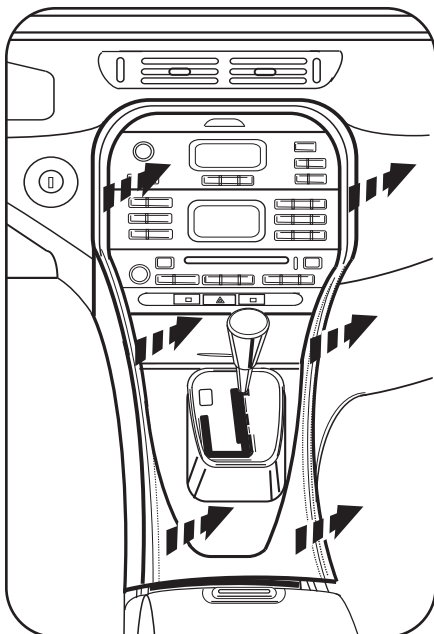
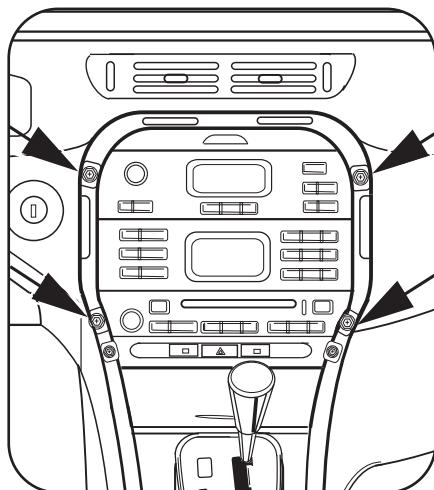
**C**

**D**

## JAGUAR X-TYPE 2002-2008

### NON-NAV MODELS

- 1** Disconnect the negative battery terminal to prevent an accidental short circuit.
- 2** Unclip and remove the trim panel around the shifter. (Figure A)
- 3** Remove (2) screws from bottom edge of ashtray assembly then unclip and remove ashtray assembly. (Figure B)
- 4** Remove (2) screws from inside ashtray cavity at bottom edge of radio. (Figure C)

*Continued on page 4*

**A**

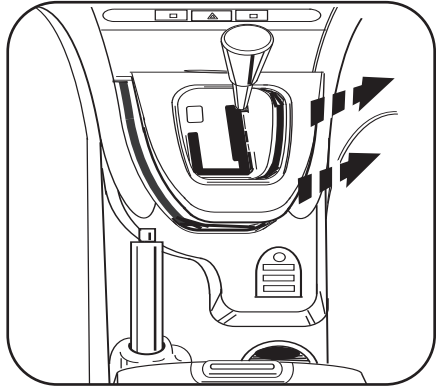

**B**

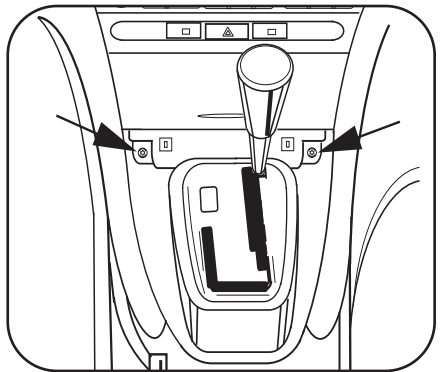

**C**

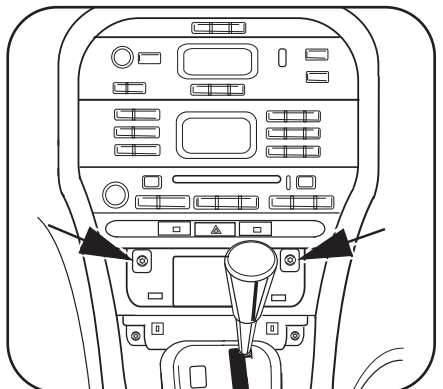

## JAGUAR X-TYPE 2002-2008

### NON-NAV MODELS

**5** Unclip, unplug and remove hazard switch/seat heater switch trim panel above climate control/radio assembly. (Figure D)

**6** Remove (2) screws from inside switch panel cavity at top edge of climate controls. (Figure E)

**7** Unplug and remove the climate control/radio assembly. (Figure F)

**8** Remove (4) screws securing the radio to the assembly and remove the radio. Retain the assembly for re-use during kit assembly.

*Continue to kit assembly*

**D**

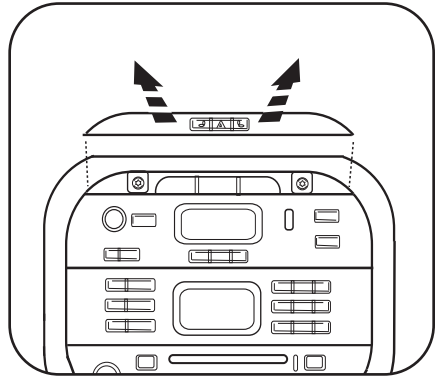

**E**

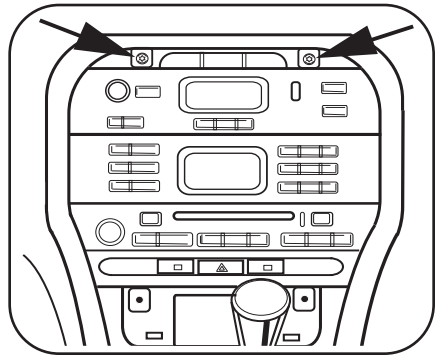

**F**

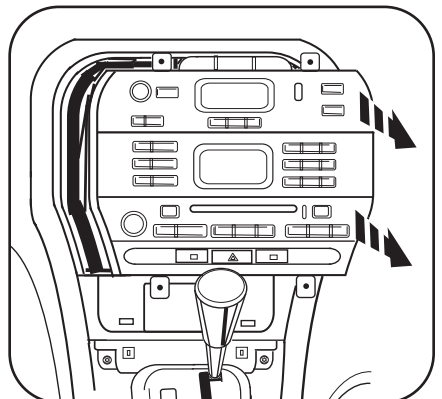

**KIT PREPARATION****JAGUAR S-TYPE 2003-08**

Cut and remove the locator closest to the face of the radio housing for the S-Type. (Figure A)

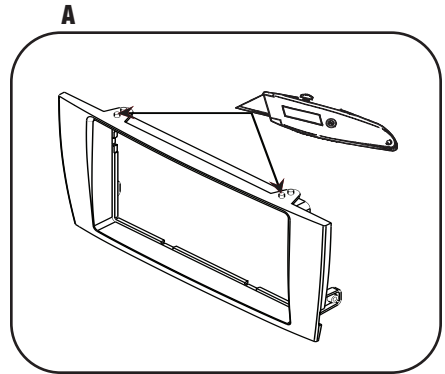
**JAGUAR X-TYPE 2002-08**

Cut and remove the locator farthest from the face of the radio housing for the X-Type. (Figure B)

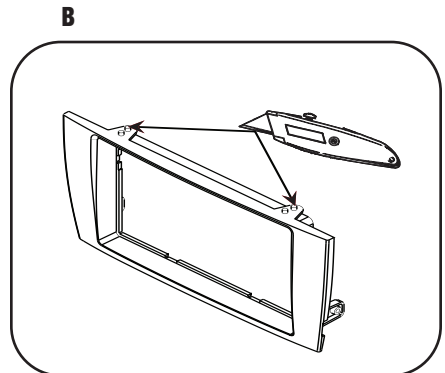

*Continue to kit assembly*

## **JAGUAR S-TYPE 2003-2008** **JAGUAR X-TYPE 2002-2008**

### **DIN HEAD UNIT PROVISION**

- 1** Locate the factory wiring harness in the dash. Metra recommends using the proper mating adapter from Metra or AXCESS. Re-connect the negative battery terminal and test the unit for proper operation.
- 2** Slide the DIN cage into the Radio Housing and secure by bending the metal locking tabs down. (Figure A)
- 3** Snap the pocket into the bottom opening of the radio housing. (Figure B)
- 4** Secure the pocket by inserting the c-clips into the opening between the pocket and the bottom of the radio housing. (Figure B)
- 5** Slide the aftermarket head unit into the cage and secure. (Figure C)
- 6** Attach the radio housing to the climate control bracket assembly and screw the bottom together with the two supplied Phillips screws.
- 7** Reassemble dash in reverse order of disassembly.

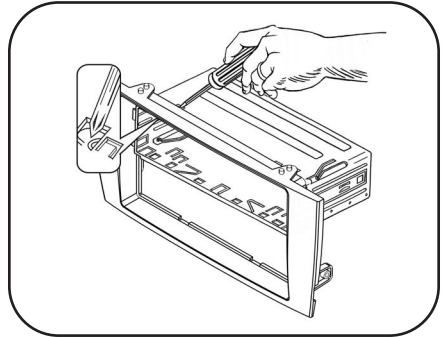
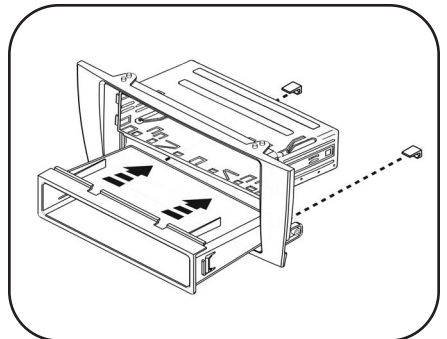
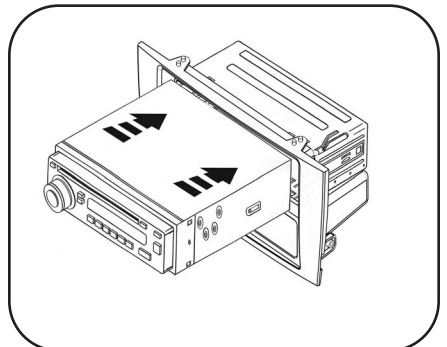
**A**

**B**

**C**

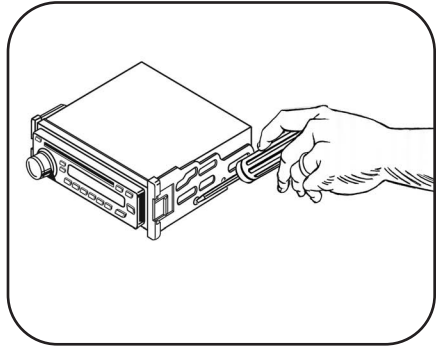
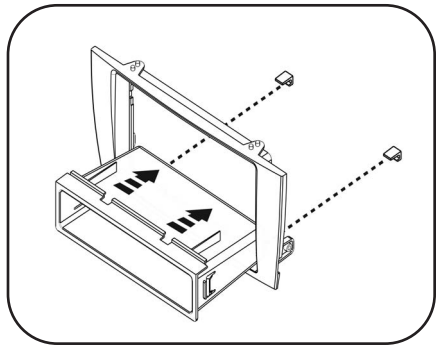
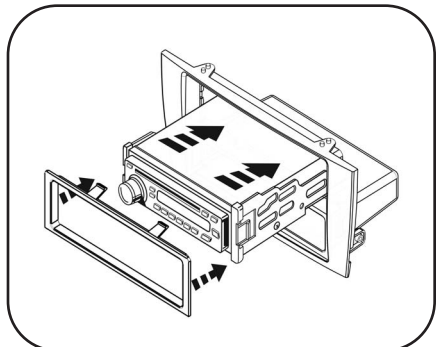

**JAGUAR S-TYPE 2003-2008**
**JAGUAR X-TYPE 2002-2008**
**ISO DIN HEAD UNIT PROVISION**

- 1 Locate the factory wiring harness in the dash. Metra recommends using the proper mating adapter from Metra or AXCESS. Re-connect the negative battery terminal and test the unit for proper operation.
- 2 Mount the ISO Brackets to the head unit with the screws supplied with the unit. (Figure A)
- 3 Snap the pocket into the bottom opening of the radio housing. (Figure B)
- 4 Secure the pocket by inserting the c-clips into the opening between the pocket and the bottom of the radio housing. (Figure B)
- 5 Slide the head unit into the radio opening until the side clips engage. (Figure C)
- 6 Snap the Trim plate into the Radio Housing. (Figure C)
- 7 Attach the radio housing to the climate control bracket assembly and screw the bottom together with the two supplied Phillips screws.
- 8 Reassemble dash in reverse order of disassembly.

**A**

**B**

**C**

**JAGUAR 5-TYPE 2003-2008**  
**JAGUAR X-TYPE 2002-2008**

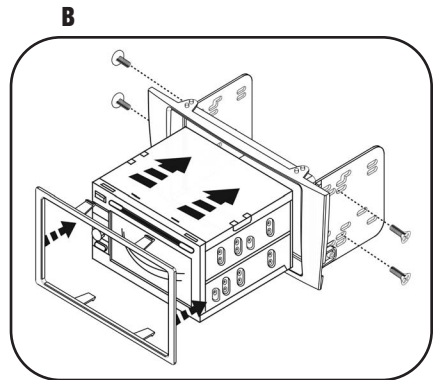
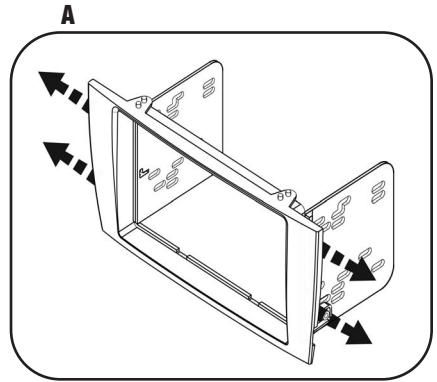
**DDIN HEAD UNIT PROVISION**

- 1** Locate the factory wiring harness in the dash. Metra recommends using the proper mating adapter from Metra or AXXESS. Re-connect the negative battery terminal and test the unit for proper operation.
- 2** Snap the Double DIN brackets to the inside edge of the Radio Housing. (Figure A)
- 3** Slide the Double DIN head unit or stacked ISO head units into the bracket/radio housing assembly and secure the Double DIN head unit or stacked ISO head units to the assembly using the screws supplied with the radio. (Figure B)
- 4** Snap the double DIN trim plate into the radio housing. (Figure B)
- 5** Attach the radio housing to the climate control bracket assembly and screw the bottom together with the two supplied Phillips screws
- 6** Reassemble dash in reverse order of disassembly.





**NOTES**

---

---

---

---

---

---

---

---

---

---

# 99-9501 INSTRUCTIONS

**METRA. THE WORLD'S BEST KITS.™**



**1-800-221-0932**



**[www.metraonline.com](http://www.metraonline.com)**

REV. 12/08/09 © COPYRIGHT 2003-2009 METRA ELECTRONICS CORPORATION INST99-9501