



Dodge Ram 1500 1998-2001/ Dodge Ram 2500/3500 1998-2002

Visit MetraOnline.com for more detailed information about the product and up-to-date vehicle specific applications

Not designed for 1998 models with single knob headlamp switch or 12 volt power outlet in upper right corner of the dash

KIT FEATURES

- ISO DDIN radio provision
- Custom textured dash panel with a DDIN radio opening.

KIT COMPONENTS

- A) Replacement dash panel • B) Radio brackets • C) Retainers • D) #8 x 1/4" Phillips screws (4) • E) Panel clips (12)

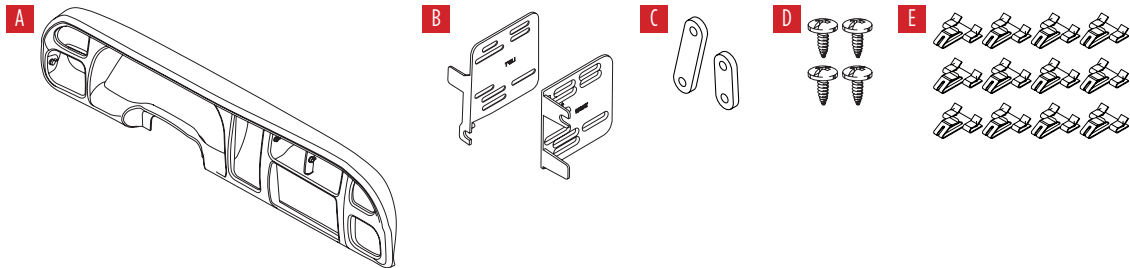

TABLE OF CONTENTS

Dash Disassembly	2
Kit Preparation	2
Kit Assembly	3

WIRING & ANTENNA CONNECTIONS (sold separately)

- Wiring Harness: 70-1817
- Antenna Adapter: Not required

TOOLS REQUIRED

- Panel removal tool • Phillips screwdriver
- 3/8" Socket wrench • Cutting tool • Scribe tool

Attention! Let the vehicle sit with the key out of the ignition for a few minutes before removing the factory radio. When testing the aftermarket equipment, ensure that all factory equipment is connected before cycling the key to ignition.

DASH DISASSEMBLY

1. Unclip, unplug and remove the dashboard trim panel. (Figure A)
2. Remove (2) 3/8" hex-head screws securing the radio to the dash. Slide the radio out, then unplug and remove

Continue to Kit Preparation

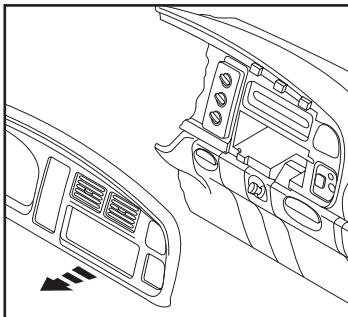

(Figure A)

KIT PREPARATION

1. Cut or grind the plastic welds from the rubber trim around the steering column area of the factory dash panel.
2. Secure the factory rubber trim to the **replacement dash panel** with the supplied retainers and screws.
3. Remove factory vents and snap them into the **replacement dash panel**. (Figure A)
4. Install the (12) **panel clips** to the **replacement dash panel**.
5. Cut the sub-dash to allow room for the radio assembly. (Figure B)

Continue to Kit Assembly

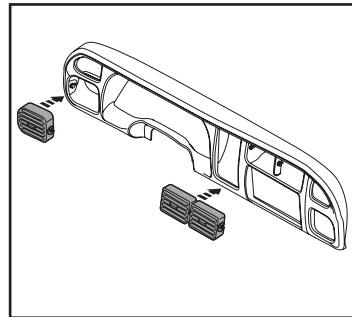

(Figure D)

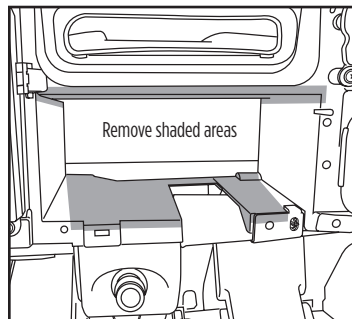

(Figure B)

KIT ASSEMBLY

1. Secure the **radio brackets** to the radio using the screws supplied with the radio. (Figure A)
2. Locate the factory wiring harness and antenna connector in the dash and complete all necessary connections to the radio. Metra recommends using the proper mating adapter from Metra and/or Axxess. Test the radio for proper operation.
3. Secure the radio assembly to the dash using the factory screws.
4. Reassemble the dash in reverse order of disassembly to complete the installation.

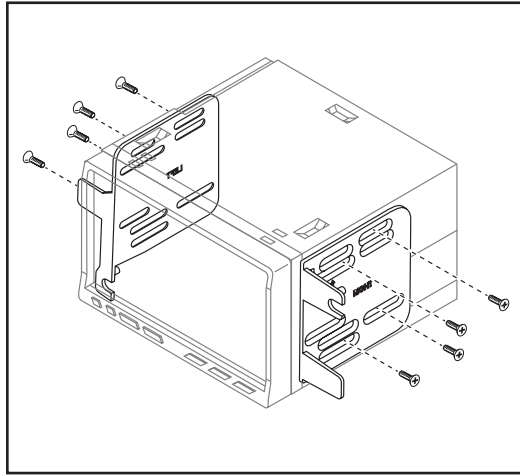

(Figure A)



DP-6551

INSTALLATION INSTRUCTIONS



Having difficulties? We're here to help.



Contact our Tech Support line at:

386-257-1187



Or via email at:

techsupport@metra-autosound.com

Tech Support Hours (Eastern Standard Time)

Monday - Friday: 9:00 AM - 7:00 PM

Saturday: 10:00 AM - 7:00 PM

Sunday: 10:00 AM - 4:00 PM



KNOWLEDGE IS POWER

Enhance your installation and fabrication skills by enrolling in the most recognized and respected mobile electronics school in our industry. Log onto www.installerinstitute.edu or call 386-672-5771 for more information and take steps toward a better tomorrow.



Metra recommends MECP certified technicians